



ASSEMBLY INSTRUCTIONS FOR 9B6305 CLUB SHELTER

THIS UNIT MUST BE ASSEMBLED BY A MINIMUM OF TWO QUALIFIED PERSONS

1. Unpack all parts and check for damage that may have occurred during shipping. If damage has occurred, notify Kwik Goal immediately. Lay out all parts. Remove all cardboard and packaging immediately. Wet or damp packaging may damage contents.
2. Read through entire instruction before beginning assembly and installation.

NOTE: Components may be packaged in one or more additional boxes.

Parts

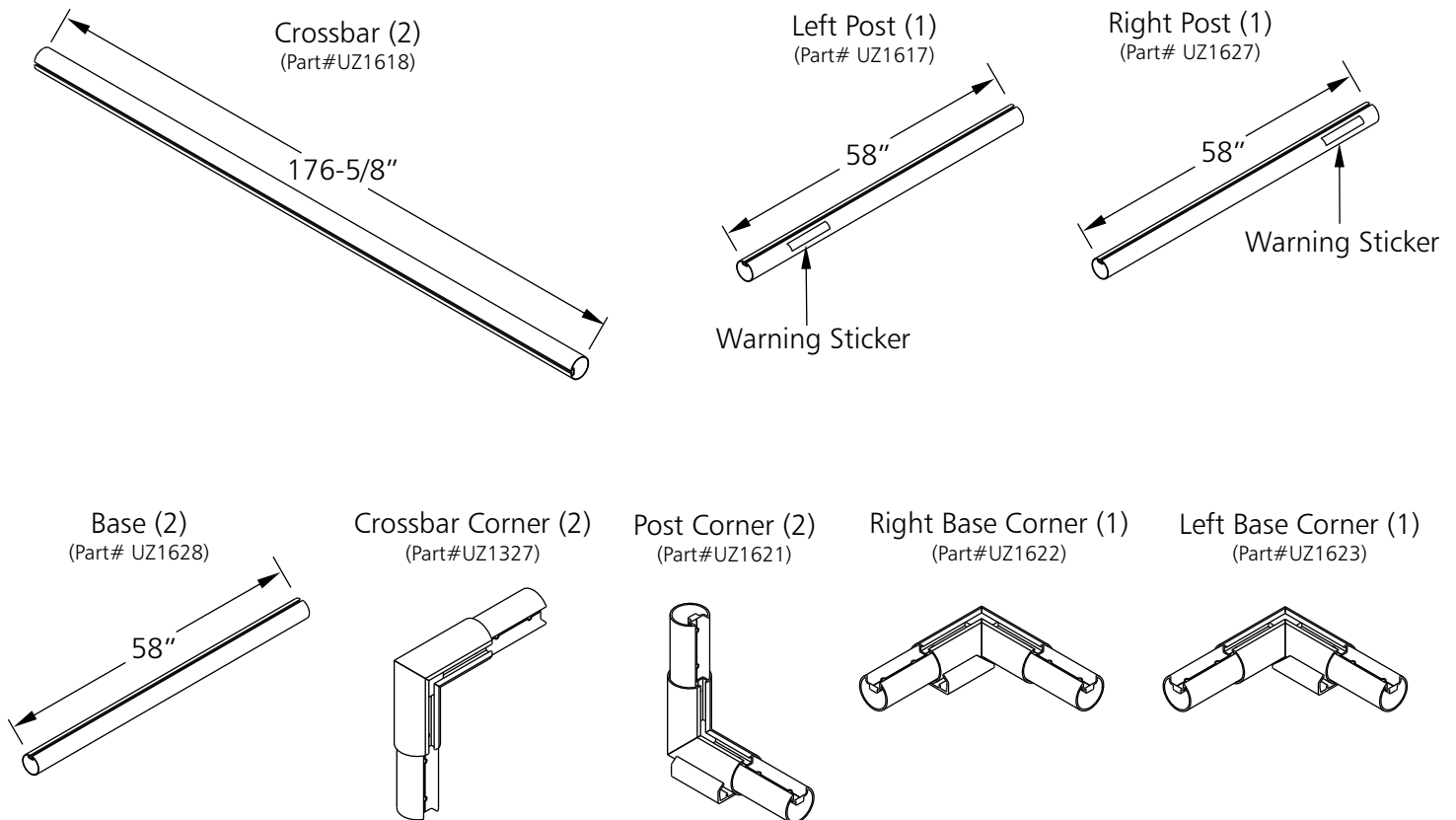

THIS UNIT MUST BE ANCHORED ACCORDING TO THESE INSTRUCTIONS AT ALL TIMES

▲WARNING

THIS EQUIPMENT MUST BE STORED IN A SECURED, SHELTERED AREA WHEN NOT IN USE OR IN THE THREAT OF HIGH WINDS. ANY WEATHER DAMAGE TO THIS EQUIPMENT WILL NOT BE COVERED UNDER KWIK GOAL'S PRODUCT GUARANTEE. DO NOT LEAVE THIS EQUIPMENT UNATTENDED.



⚠ WARNING

IMPORTANT SAFETY INSTRUCTIONS

READ CAREFULLY

1. All Kwik Goal shelters must be moved by qualified personnel who are experienced in moving field equipment.
2. A minimum of two qualified, experienced people are required to move shelter.
3. Do not attempt to lift or move shelter in windy conditions.
4. Shelters must not be left unattended and unsecured.
5. Shelter must be on level, flat ground at all times.
6. Use extreme caution when pushing shelter. Excessive force can overturn shelter. Always push at lowest point on shelter frame possible.
7. Do not push shelter directly from the front to rear or rear to front. Push from end to end.

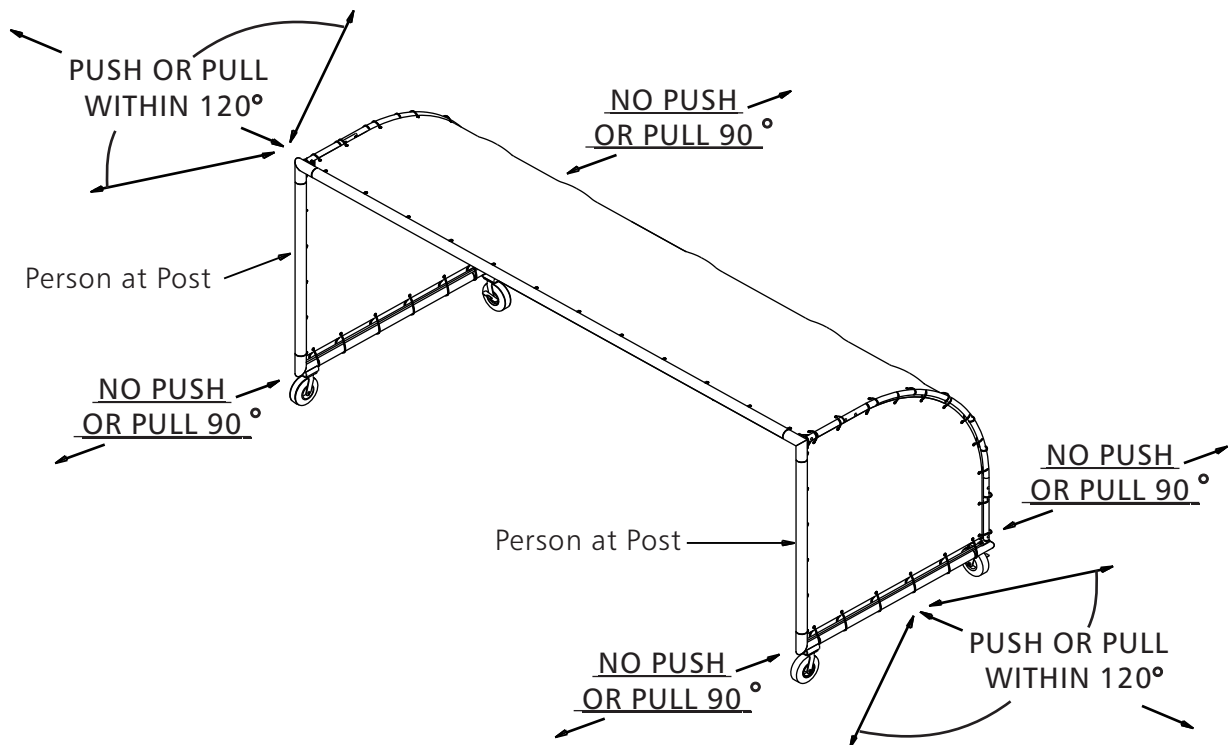

NEVER LEAVE SHELTERS UNATTENDED AND UNSECURED

Parts Continued

End Frame Bow (2)
(Part# UZ1620)

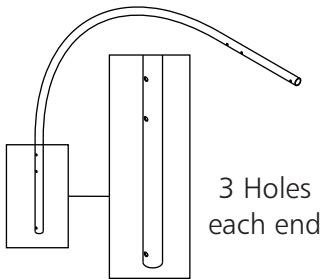

Center Frame Bow (3)
(Part# UZ1619)

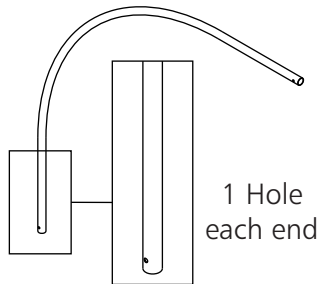

Left Side Cover (1)
(Part# VZ835)

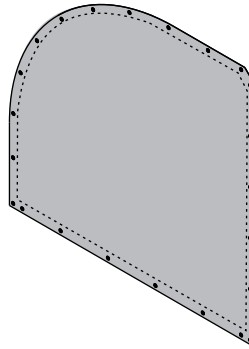

Right Side Cover (1)
(Part# VZ836)

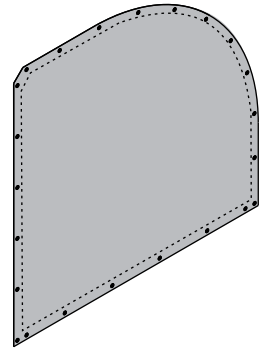

Center Cover (1)
(Part# VZ834)

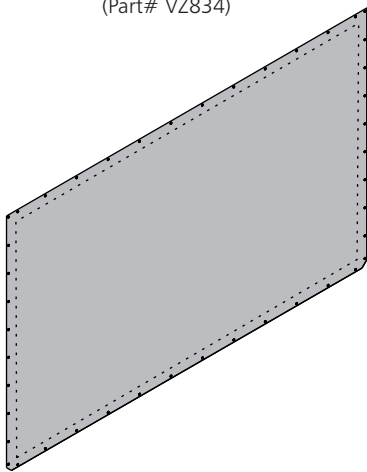

Swivel Wheel (2)
(Part# VZ688)



Swivel Wheel
w/ Brake (2)
(Part# VZ840)

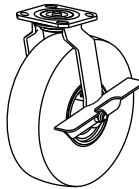

Ground Anchor (4)
w/hardware
(Part# 10B103 Set of 4)



Bow Brace (4)
(Part# UZ1609)

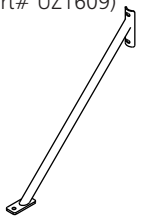

Bow Connector (2)
Right Top / Bottom Left
(Part# UZ1624)

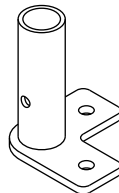

Bow Connector (2)
Left Top / Bottom Right
(Part# UZ1625)

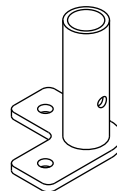

Bow Connector (6)
Center Top & Bottom
(Part# UZ1626)

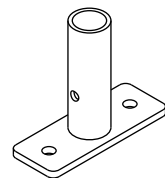

Anchor Plate and Chain (4)
(Part# UZ846)

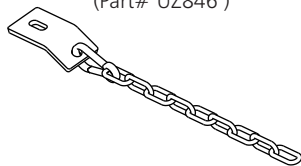

Cover Clip (24)
(Part# JZ240-24)

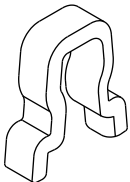

Bow Bungees (42)
(Part# JZ237-01)

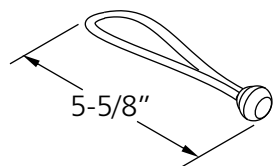

Base Bungees (24)
(Part# JZ237-02)

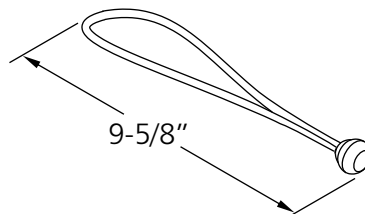

Kwik Fill Anchor Bag (4)
(Part# 10B5909)

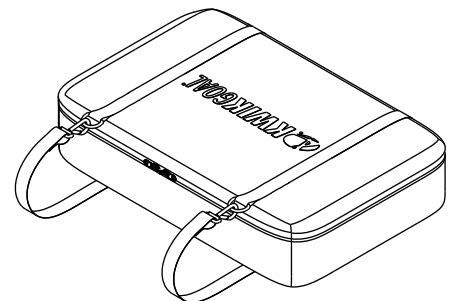

THIS UNIT MUST BE ANCHORED ACCORDING TO THESE INSTRUCTIONS AT ALL TIMES

⚠ WARNING

THIS EQUIPMENT MUST BE STORED IN A SECURED, SHELTERED AREA WHEN NOT IN USE OR IN THE THREAT OF HIGH WINDS. ANY WEATHER DAMAGE TO THIS EQUIPMENT WILL NOT BE COVERED UNDER KWIK GOAL'S PRODUCT GUARANTEE. DO NOT LEAVE THIS EQUIPMENT UNATTENDED.

Note: Hardware is packed separately in one or more boxes. Open all boxes and layout all sealed hardware packs before beginning assembly.

Frame Hdw (Part#JZ238)

5/16" X 1" Hex Bolts (Part# TZ330)	(16)
5/16" Square Nut (Part# TZ400)	(14)
5/16" Lock Washer (Part# TZ174)	(16)
5/16" Flat Washer (Part# TZ4)	(16)
3/8" X 1" Socket Head (Part# TZ323)	(24)
3/8" Square Nut (Part# TZ247)	(24)
3/8" Lock Washer (Part# TZ65)	(24)

Bow Hdw (Part# JZ239)

5/16" X 2" Hex Bolt (Part# TZ184)	(6)
5/16" X 2" Carriage Bolt (Part# TZ401)	(12)
5/16" Hex Nut (Part# TZ173)	(12)
5/16" Lock Nut (Part# TZ5)	(6)
5/16" Lock Washer (Part# TZ174)	(12)
5/16" Flat Washer (Part# TZ4)	(24)
3/8" X 7/8" Hex Bolt (Part# TZ249)	(24)
3/8" Lock Washer (Part# TZ65)	(24)
3/8" Flat Washer (Part# TZ60)	(24)

Anchor Hdw (Part#JZ78)

3/8" X 7/8" Hex Bolt (Part# TZ249)	(4)
3/8" Square Nut (Part# TZ247)	(4)
3/8" Lock Washer (Part# TZ65)	(4)
3/8" Flat Washer (Part# TZ60)	(4)

Assembly Tools

1/2" & 9/16"
Wrenches

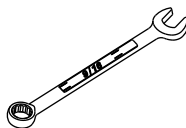

Ratchet with
1/2" & 9/16"
Sockets

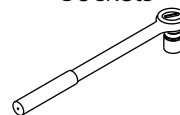

5/16" Hex wrench



THIS UNIT MUST BE ANCHORED ACCORDING TO THESE INSTRUCTIONS AT ALL TIMES

▲WARNING

THIS EQUIPMENT MUST BE STORED IN A SECURED, SHELTERED AREA WHEN NOT IN USE OR IN THE THREAT OF HIGH WINDS. ANY WEATHER DAMAGE TO THIS EQUIPMENT WILL NOT BE COVERED UNDER KWIK GOAL'S PRODUCT GUARANTEE. DO NOT LEAVE THIS EQUIPMENT UNATTENDED.

3. Hardware for steps 3 through 7 is in the **Frame Hdw** pack and the **Anchor Hdw** pack.
Attach swivel wheels w/ brakes to right & left base corners as shown.

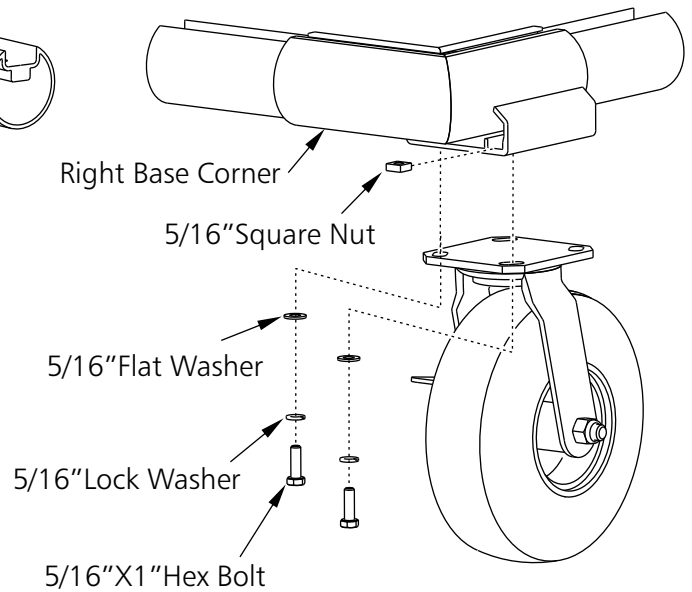
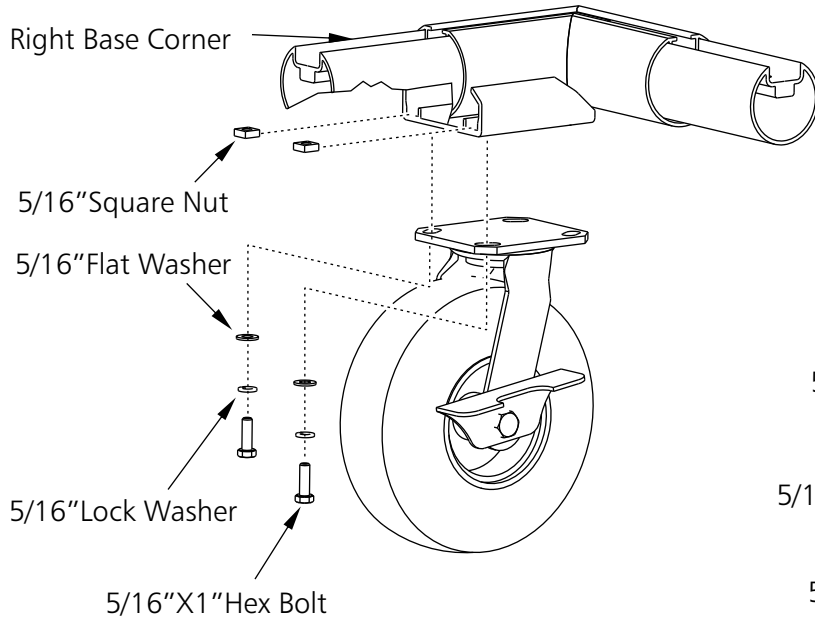

4. Attach swivel wheels to post corners as shown.

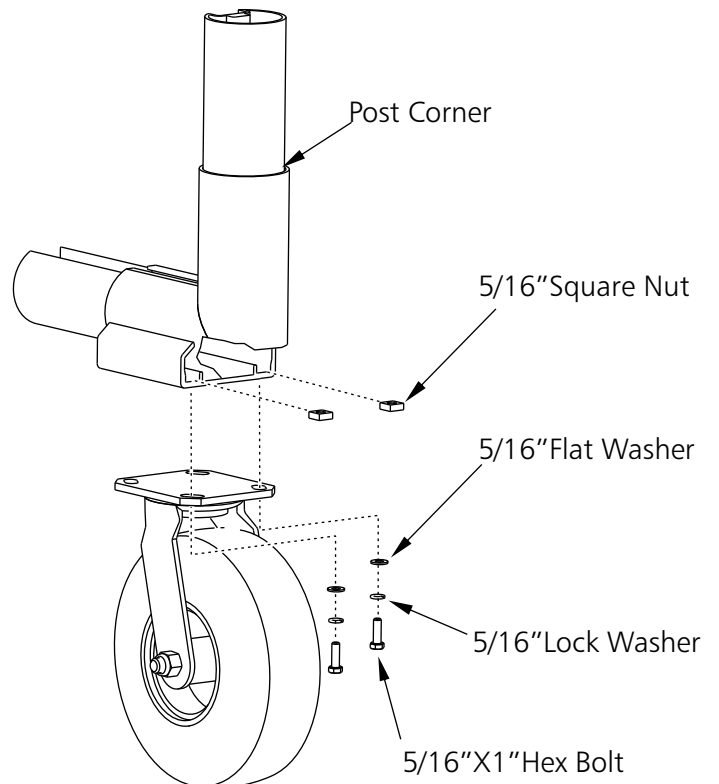
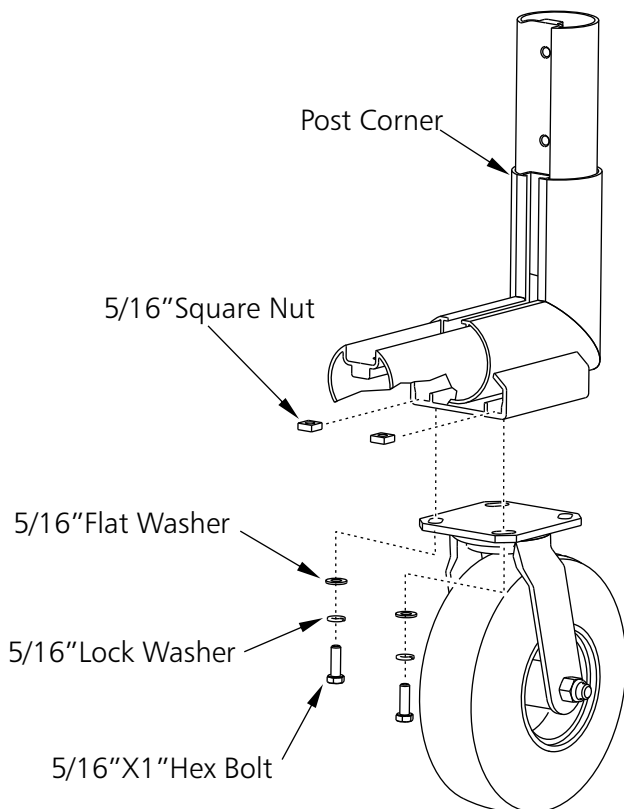

THIS UNIT MUST BE ANCHORED ACCORDING TO THESE INSTRUCTIONS AT ALL TIMES

⚠ WARNING

THIS EQUIPMENT MUST BE STORED IN A SECURED, SHELTERED AREA WHEN NOT IN USE OR IN THE THREAT OF HIGH WINDS. ANY WEATHER DAMAGE TO THIS EQUIPMENT WILL NOT BE COVERED UNDER KWIK GOAL'S PRODUCT GUARANTEE. DO NOT LEAVE THIS EQUIPMENT UNATTENDED.

5. Assemble crossbar, posts, crossbar corners, and post corners.

NOTE: Square nuts will float loose in channels until used later. Do NOT tighten bolts at this time.

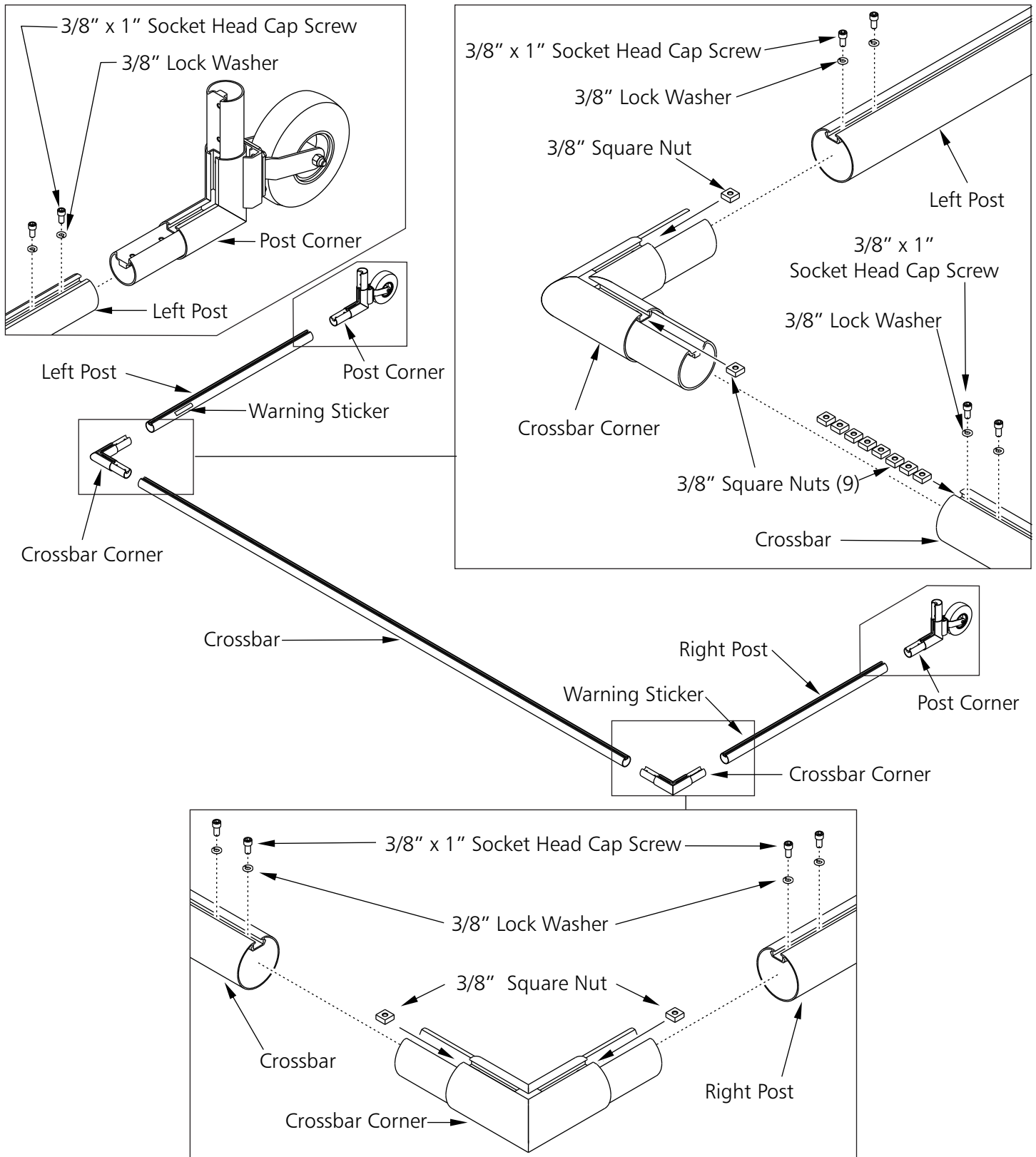

THIS UNIT MUST BE ANCHORED ACCORDING TO THESE INSTRUCTIONS AT ALL TIMES

⚠ WARNING

THIS EQUIPMENT MUST BE STORED IN A SECURED, SHELTERED AREA WHEN NOT IN USE OR IN THE THREAT OF HIGH WINDS. ANY WEATHER DAMAGE TO THIS EQUIPMENT WILL NOT BE COVERED UNDER KVIK GOAL'S PRODUCT GUARANTEE. DO NOT LEAVE THIS EQUIPMENT UNATTENDED.

6. Assemble crossbar, bases, left and right base corners.

NOTE: Square nuts will float loose in channels until used later. Do NOT tighten bolts at this time.

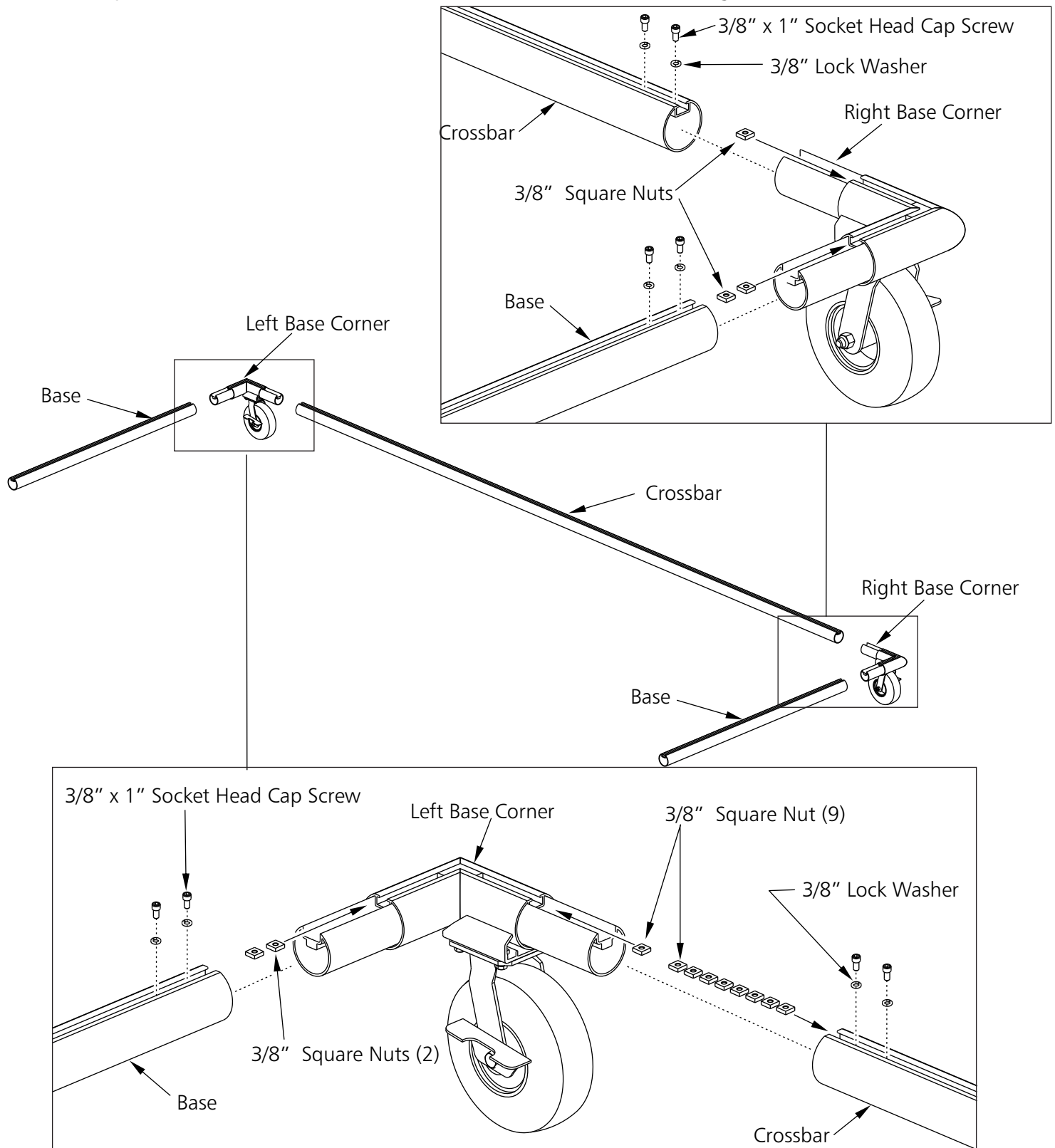

THIS UNIT MUST BE ANCHORED ACCORDING TO THESE INSTRUCTIONS AT ALL TIMES

⚠ WARNING

THIS EQUIPMENT MUST BE STORED IN A SECURED, SHELTERED AREA WHEN NOT IN USE OR IN THE THREAT OF HIGH WINDS. ANY WEATHER DAMAGE TO THIS EQUIPMENT WILL NOT BE COVERED UNDER KWIK GOAL'S PRODUCT GUARANTEE. DO NOT LEAVE THIS EQUIPMENT UNATTENDED.

7. Attach assembled base to post corners as shown. **Note: Tighten all bolts at this time.**

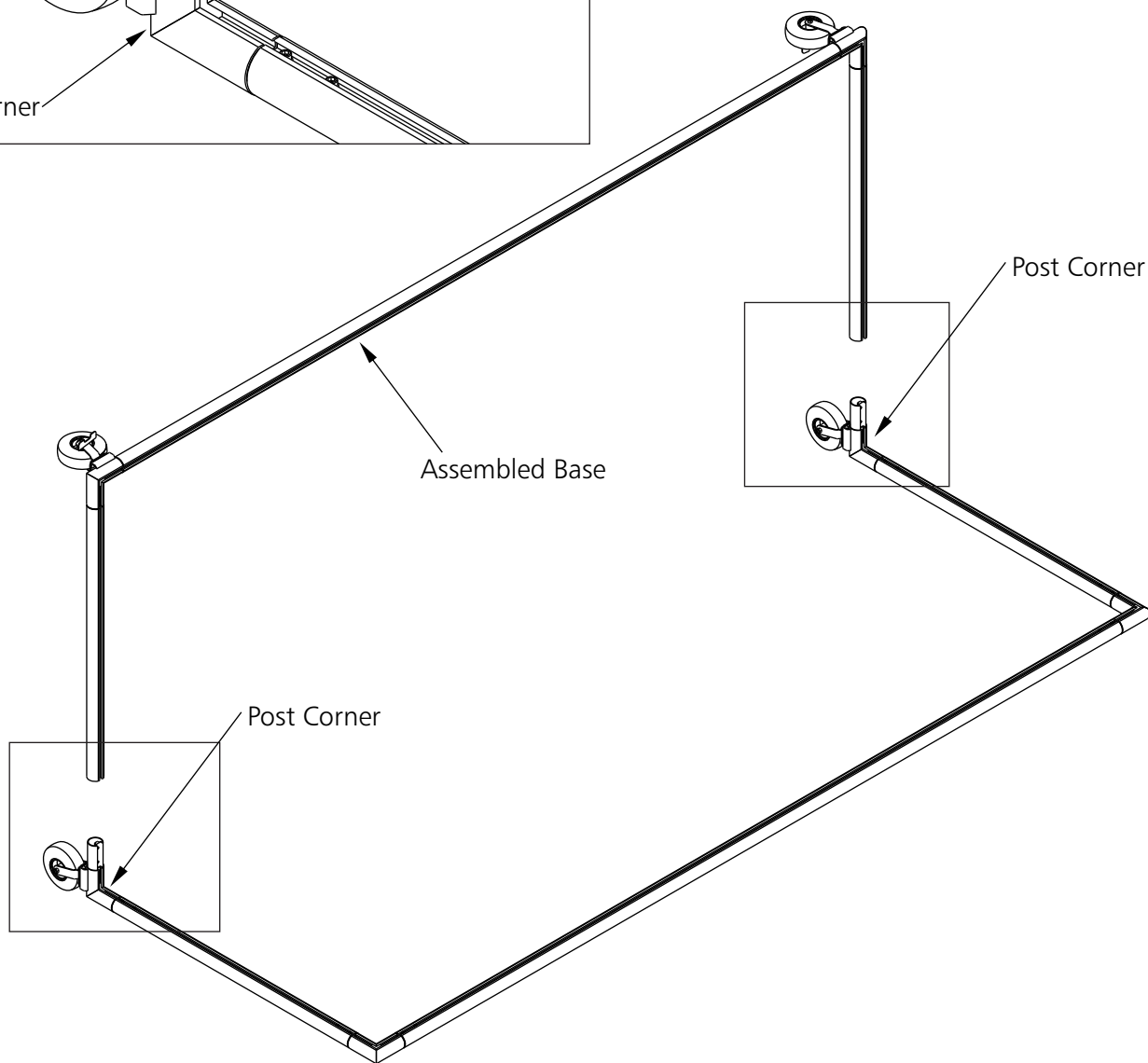
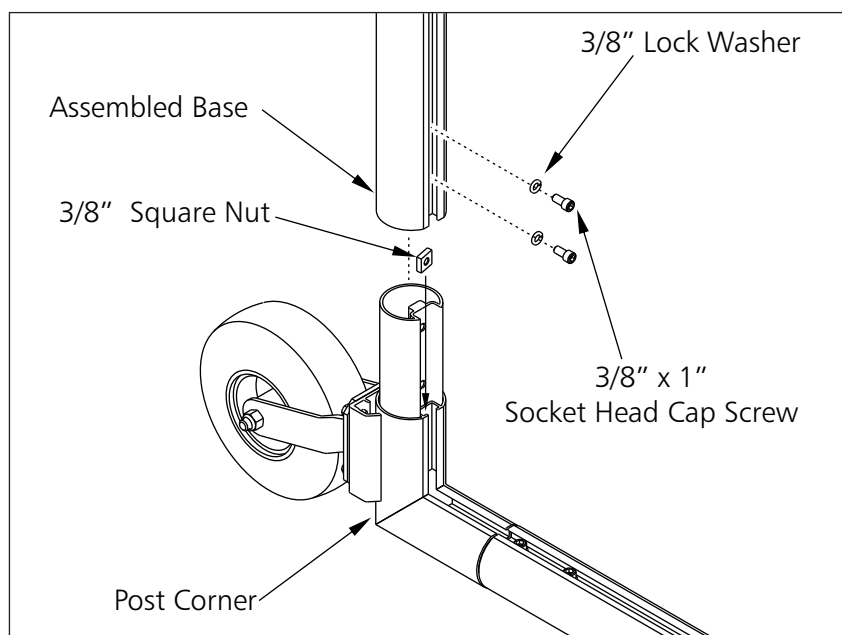

THIS UNIT MUST BE ANCHORED ACCORDING TO THESE INSTRUCTIONS AT ALL TIMES

⚠ WARNING

THIS EQUIPMENT MUST BE STORED IN A SECURED, SHELTERED AREA WHEN NOT IN USE OR IN THE THREAT OF HIGH WINDS. ANY WEATHER DAMAGE TO THIS EQUIPMENT WILL NOT BE COVERED UNDER KWIK GOAL'S PRODUCT GUARANTEE. DO NOT LEAVE THIS EQUIPMENT UNATTENDED.

8. Hardware for steps 8 through is in 13 **Bow Hdw** pack.
Attach right & left top bow connectors to assembled frame using 3/8" square nuts at crossbar corners as shown.

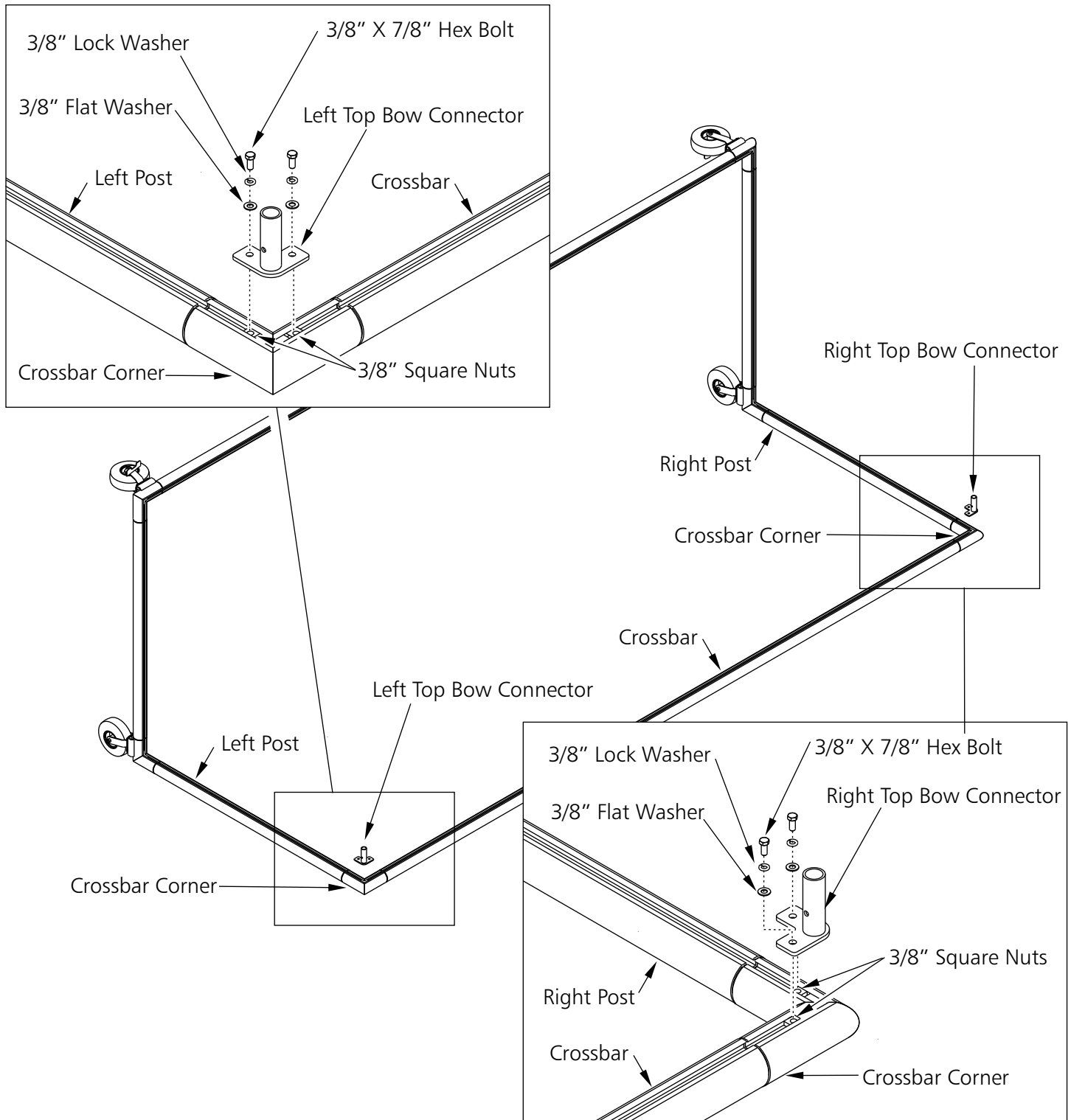

THIS UNIT MUST BE ANCHORED ACCORDING TO THESE INSTRUCTIONS AT ALL TIMES

⚠ WARNING

THIS EQUIPMENT MUST BE STORED IN A SECURED, SHELTERED AREA WHEN NOT IN USE OR IN THE THREAT OF HIGH WINDS. ANY WEATHER DAMAGE TO THIS EQUIPMENT WILL NOT BE COVERED UNDER KWIK GOAL'S PRODUCT GUARANTEE. DO NOT LEAVE THIS EQUIPMENT UNATTENDED.

9. Starting at left top bow connector push five 3/8" square nuts towards the right top bow connector. Skip one 3/8" square nut and attach center bow connectors to crossbar at locations shown.

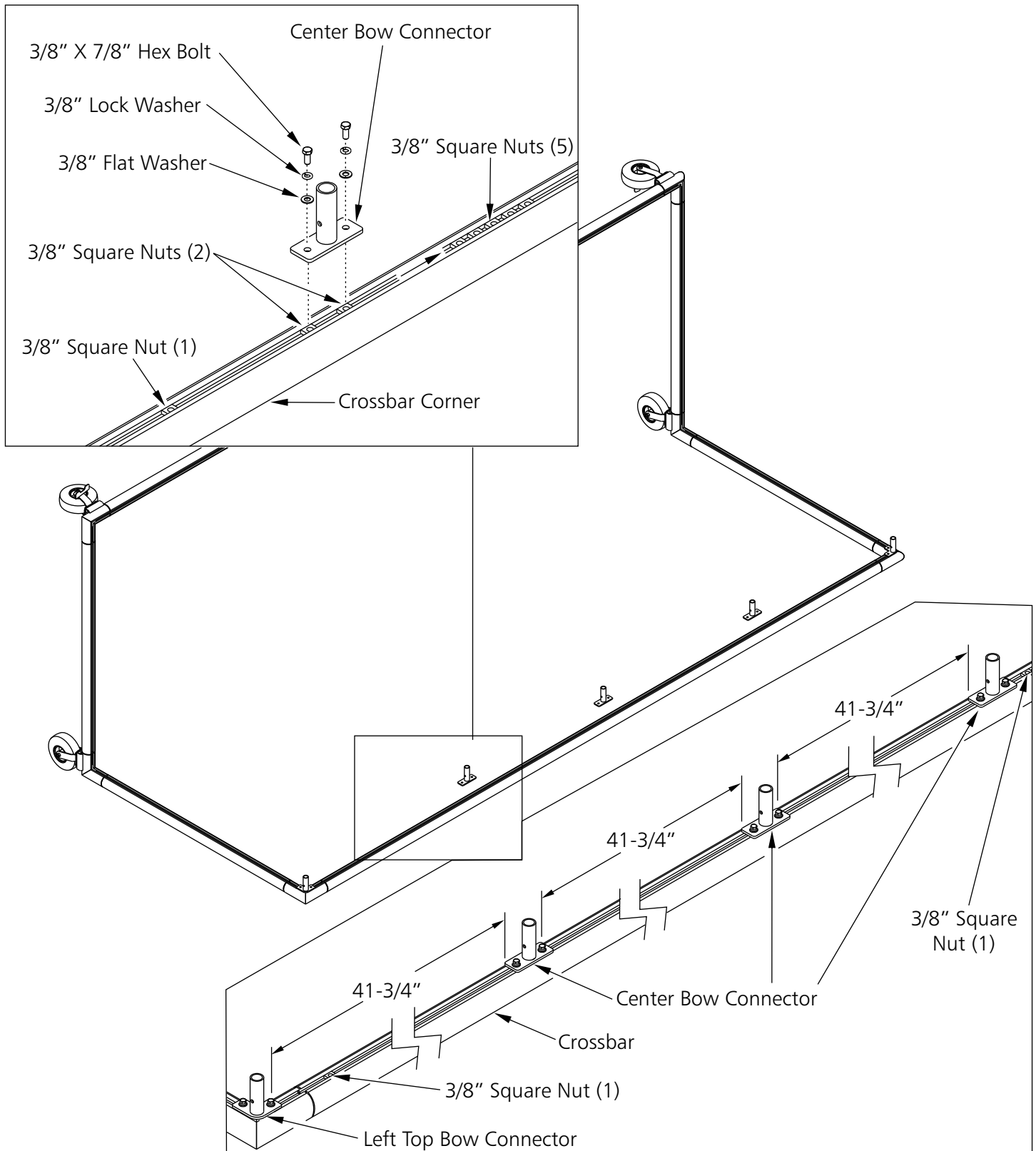

THIS UNIT MUST BE ANCHORED ACCORDING TO THESE INSTRUCTIONS AT ALL TIMES

⚠ WARNING

THIS EQUIPMENT MUST BE STORED IN A SECURED, SHELTERED AREA WHEN NOT IN USE OR IN THE THREAT OF HIGH WINDS. ANY WEATHER DAMAGE TO THIS EQUIPMENT WILL NOT BE COVERED UNDER KWIK GOAL'S PRODUCT GUARANTEE. DO NOT LEAVE THIS EQUIPMENT UNATTENDED.

10. Assemble left and right end frame bows as shown.

Note: May need to draw 5/16" X 2" carriage bolt head into hole by just using 5/16" flat washer and 5/16" hex nut first then remove 5/16" hex nut add lock washer. Do NOT tighten bolts at this time.

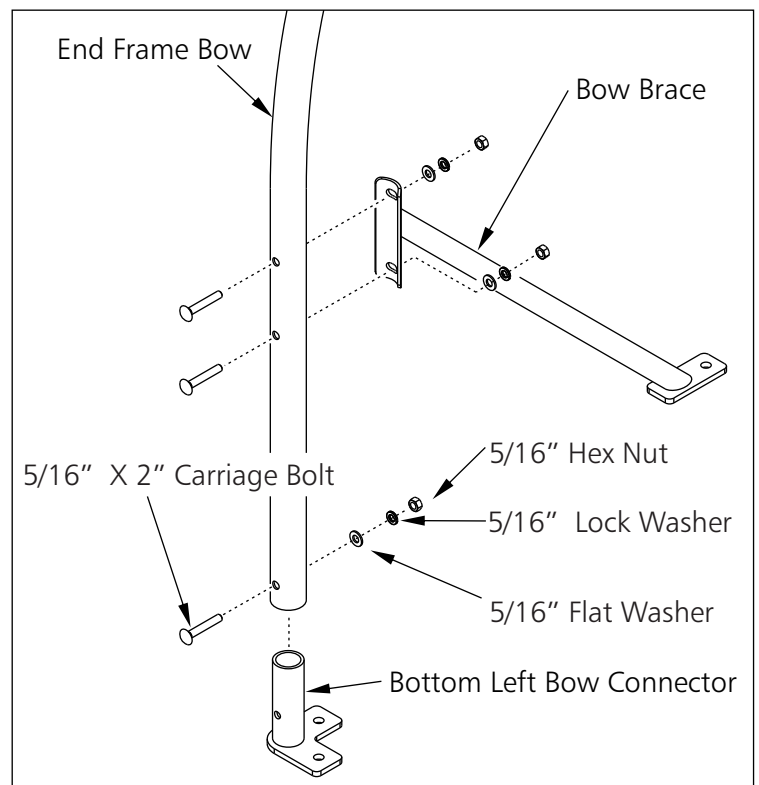
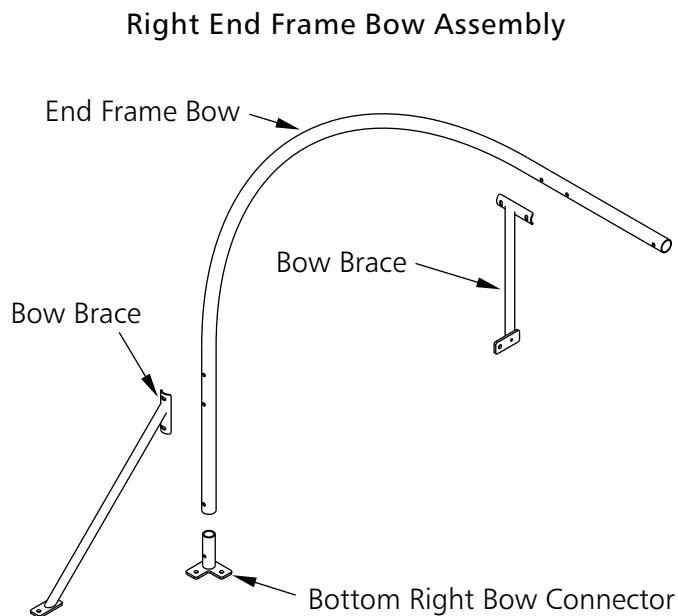
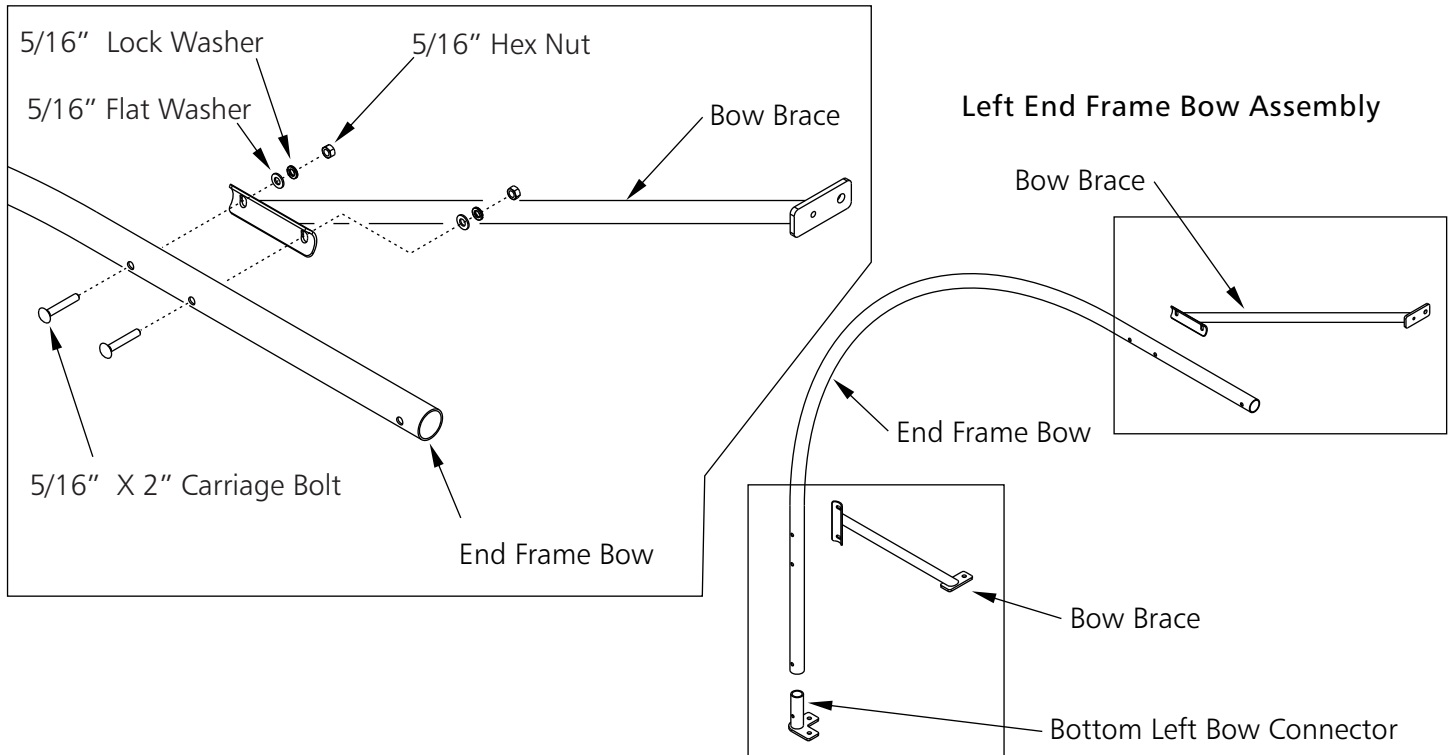

THIS UNIT MUST BE ANCHORED ACCORDING TO THESE INSTRUCTIONS AT ALL TIMES

⚠ WARNING

THIS EQUIPMENT MUST BE STORED IN A SECURED, SHELTERED AREA WHEN NOT IN USE OR IN THE THREAT OF HIGH WINDS. ANY WEATHER DAMAGE TO THIS EQUIPMENT WILL NOT BE COVERED UNDER KWIK GOAL'S PRODUCT GUARANTEE. DO NOT LEAVE THIS EQUIPMENT UNATTENDED.

11. Attach left and right frame bows to bow connectors at crossbar corners. **Do NOT tighten bolts at this time.**

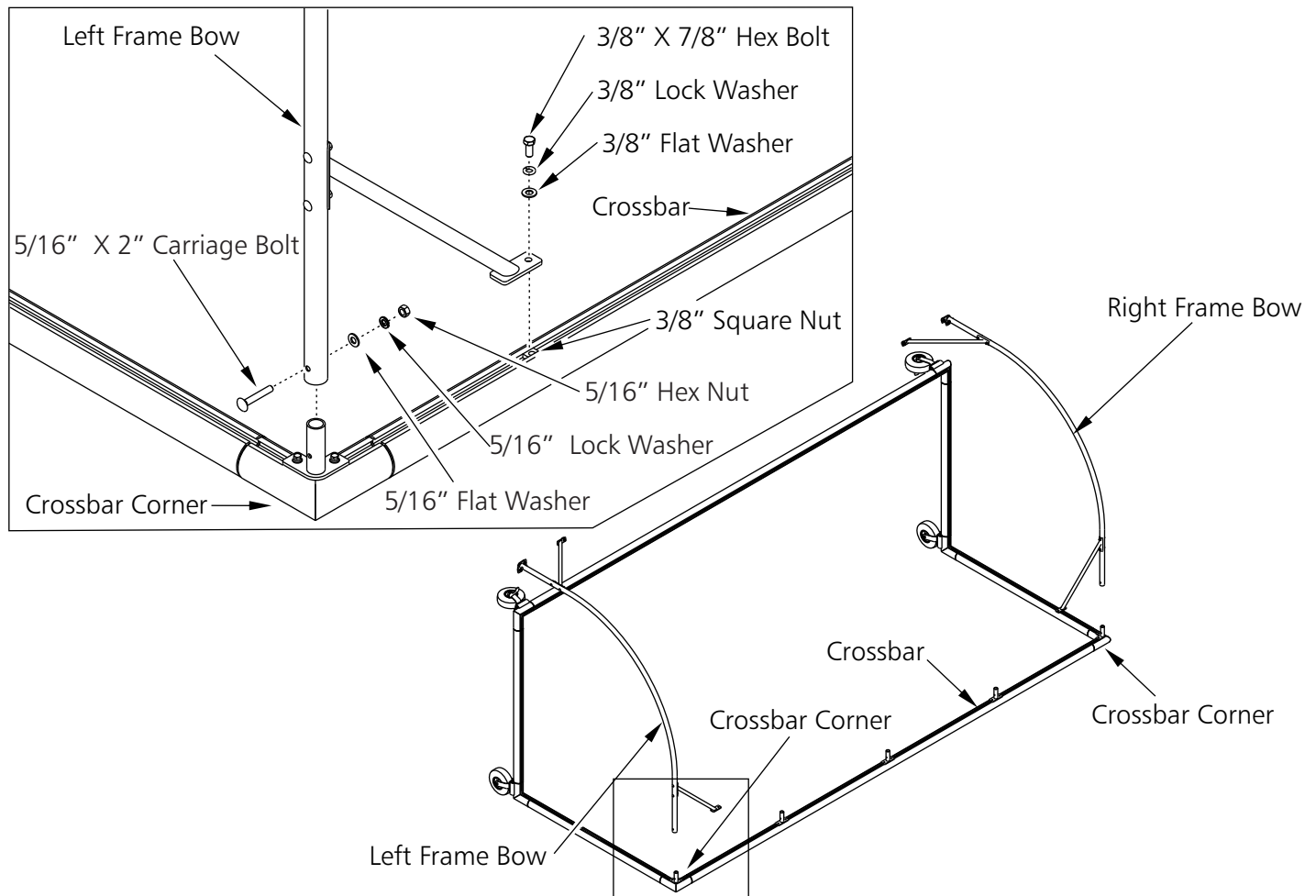

12. Attach left and right frame bow to base corner and crossbar using 3/8" square nuts. **Square up all parts and tighten bolts at this time.**

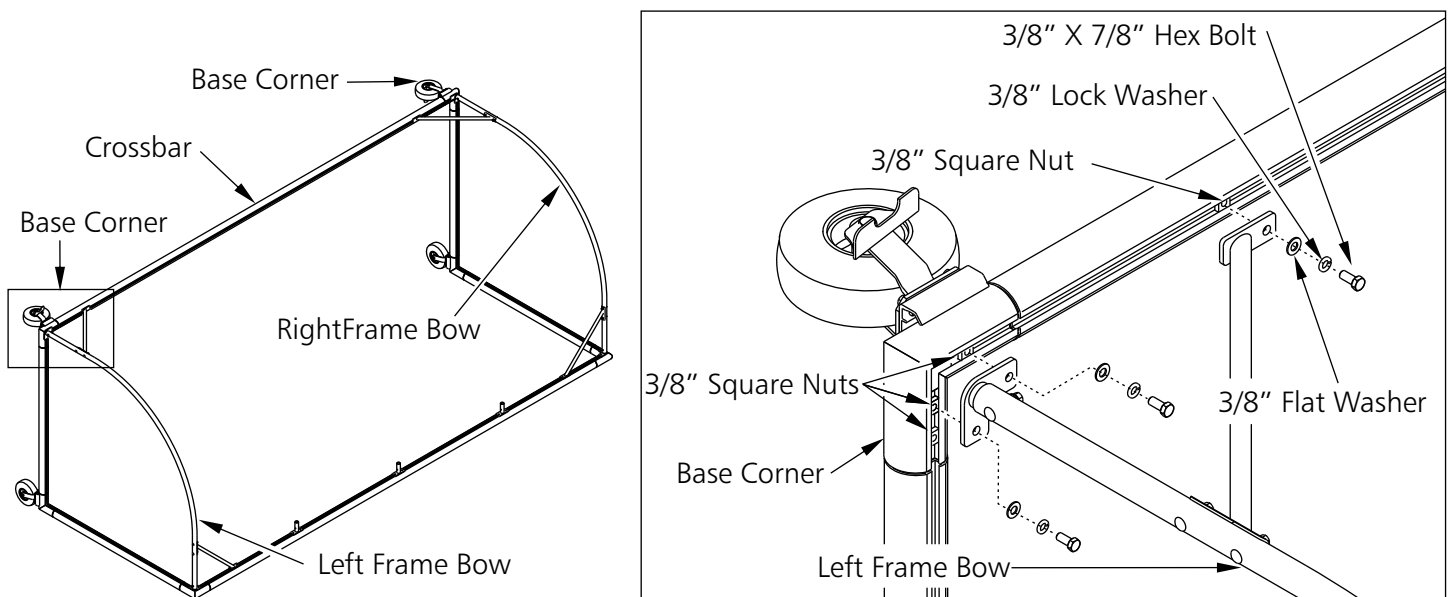

THIS UNIT MUST BE ANCHORED ACCORDING TO THESE INSTRUCTIONS AT ALL TIMES

⚠ WARNING

THIS EQUIPMENT MUST BE STORED IN A SECURED, SHELTERED AREA WHEN NOT IN USE OR IN THE THREAT OF HIGH WINDS. ANY WEATHER DAMAGE TO THIS EQUIPMENT WILL NOT BE COVERED UNDER KWIK GOAL'S PRODUCT GUARANTEE. DO NOT LEAVE THIS EQUIPMENT UNATTENDED.

13. Attach one center bow connector to all three center frame bows.

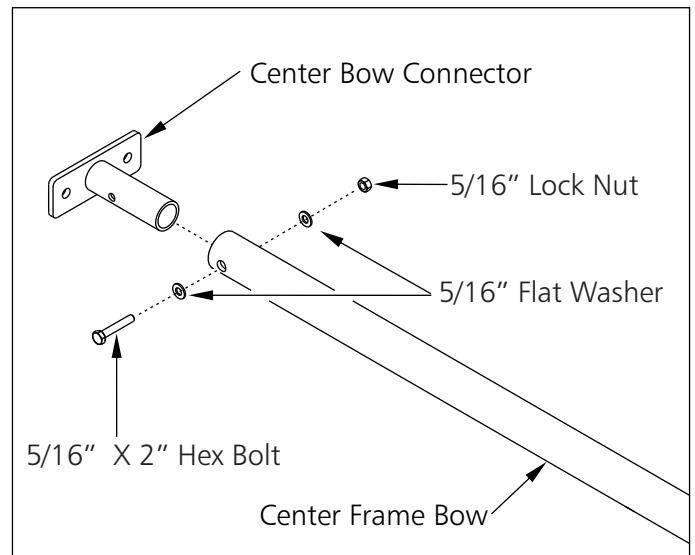
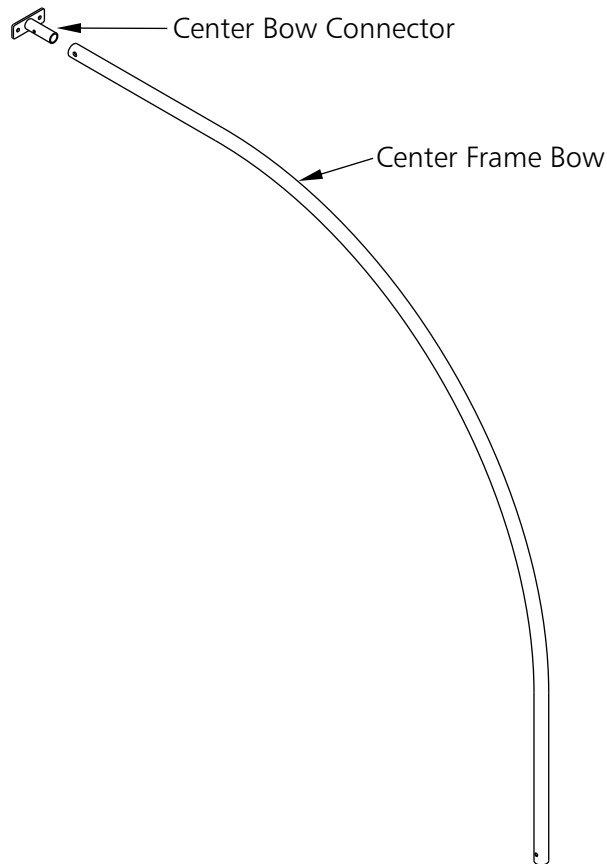

14. Attach center frame bows to crossbar at center bow connector locations.

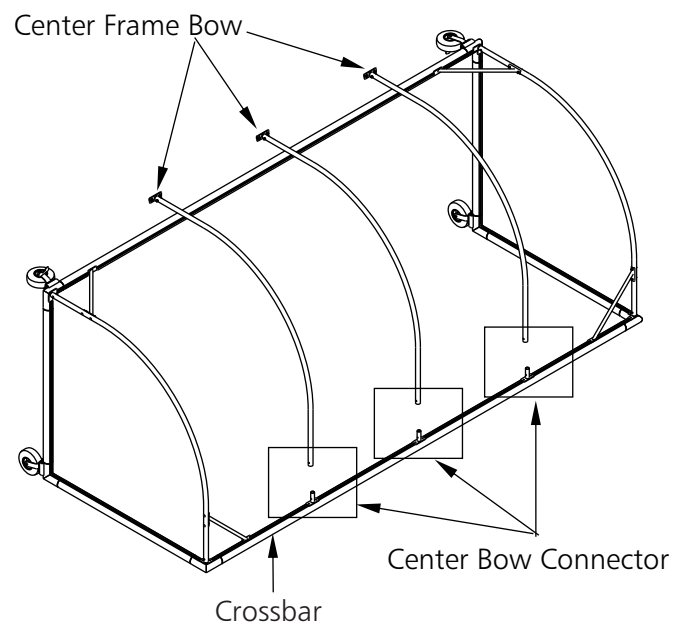
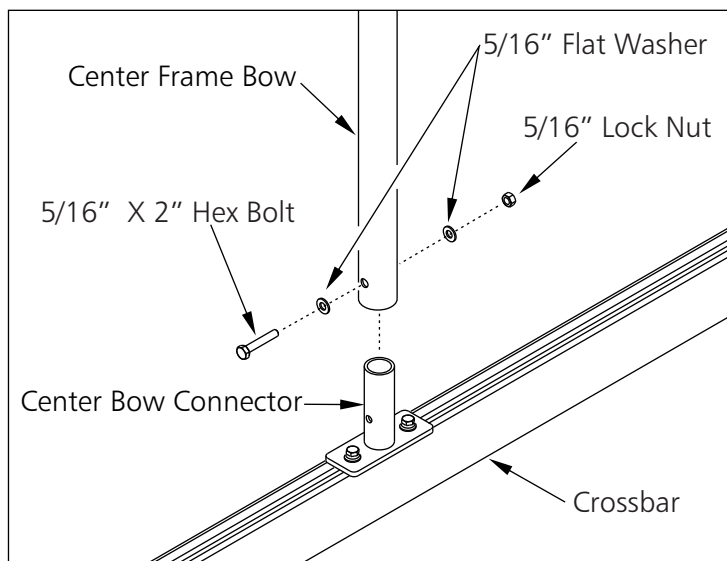

THIS UNIT MUST BE ANCHORED ACCORDING TO THESE INSTRUCTIONS AT ALL TIMES

⚠WARNING

THIS EQUIPMENT MUST BE STORED IN A SECURED, SHELTERED AREA WHEN NOT IN USE OR IN THE THREAT OF HIGH WINDS. ANY WEATHER DAMAGE TO THIS EQUIPMENT WILL NOT BE COVERED UNDER KWIK GOAL'S PRODUCT GUARANTEE. DO NOT LEAVE THIS EQUIPMENT UNATTENDED.

15. Attach center frame bows to crossbar using 3/8" square nuts at locations shown.

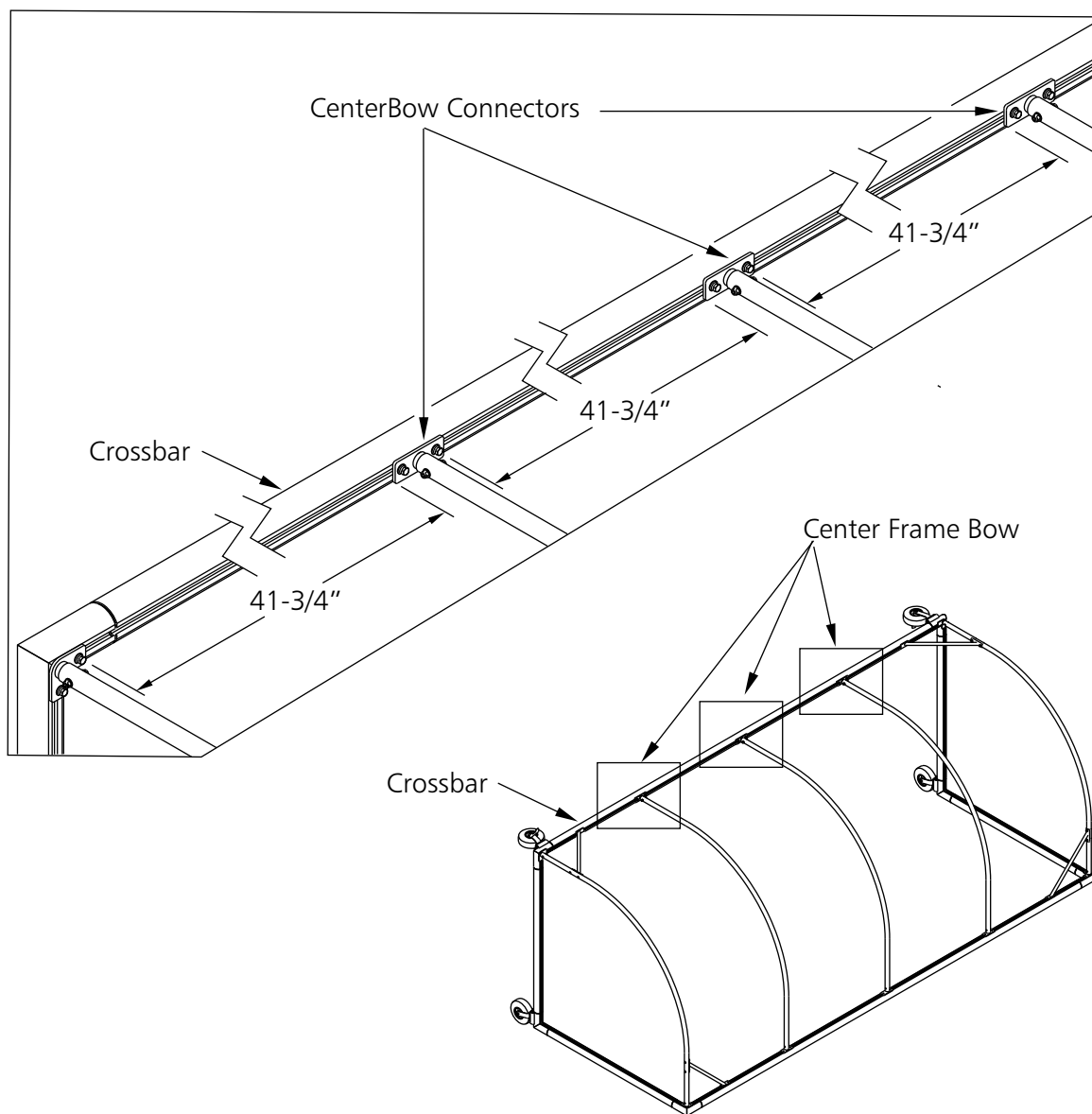
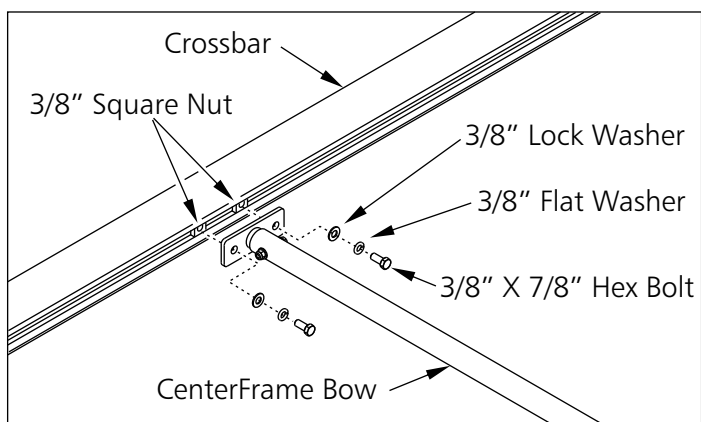

THIS UNIT MUST BE ANCHORED ACCORDING TO THESE INSTRUCTIONS AT ALL TIMES

⚠ WARNING

THIS EQUIPMENT MUST BE STORED IN A SECURED, SHELTERED AREA WHEN NOT IN USE OR IN THE THREAT OF HIGH WINDS. ANY WEATHER DAMAGE TO THIS EQUIPMENT WILL NOT BE COVERED UNDER KWIK GOAL'S PRODUCT GUARANTEE. DO NOT LEAVE THIS EQUIPMENT UNATTENDED.

16. Lay out center cover along crossbar with angled corners toward crossbar and hem edge up. Making sure center cover is evenly spaced between left and right post, attach center cover to left crossbar corner with cover clip as shown.

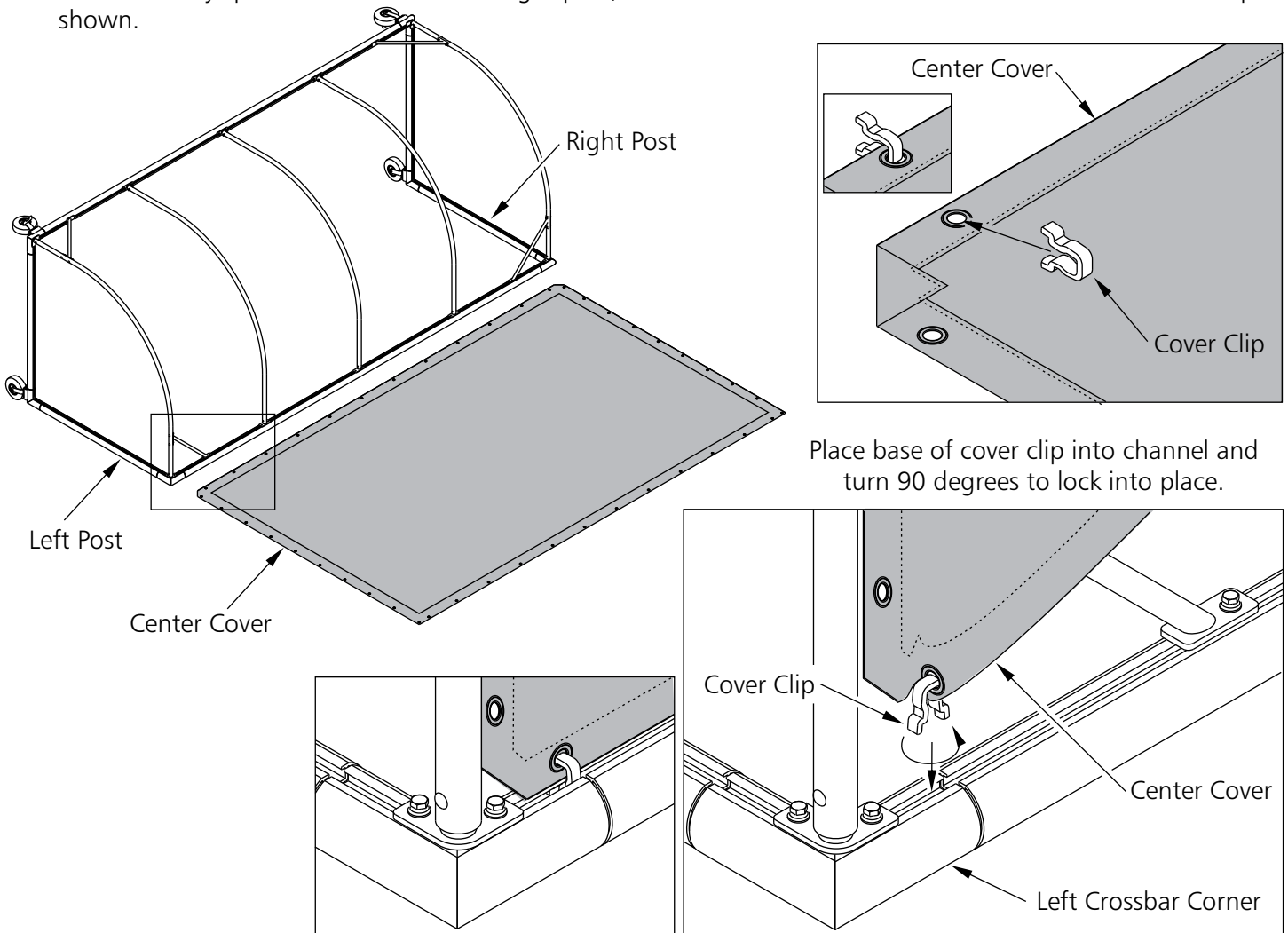

17. Attach center cover to left frame bow at grommet with bow bungee as shown. Repeat steps 16 & 17 to attach right side of center cover to shelter frame.

Note: For a clean look keep bungee ball on the inside of cover

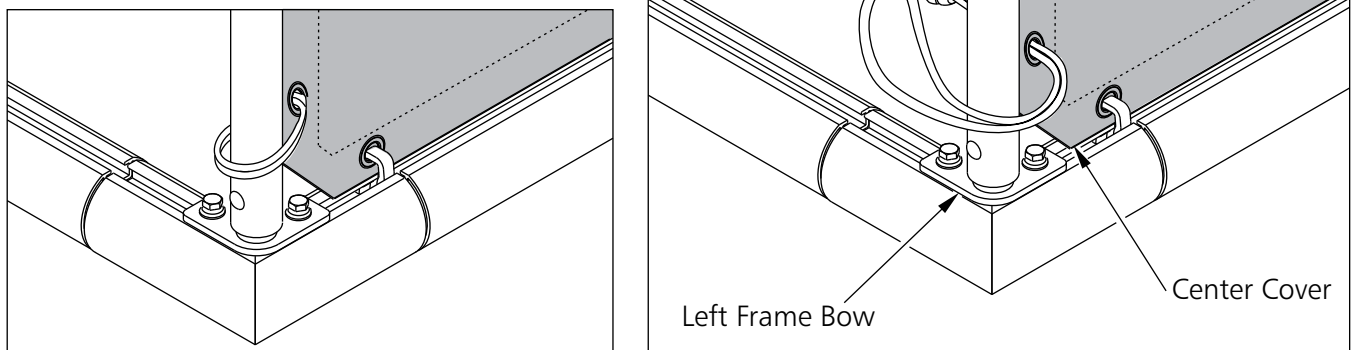

THIS UNIT MUST BE ANCHORED ACCORDING TO THESE INSTRUCTIONS AT ALL TIMES

⚠ WARNING

THIS EQUIPMENT MUST BE STORED IN A SECURED, SHELTERED AREA WHEN NOT IN USE OR IN THE THREAT OF HIGH WINDS. ANY WEATHER DAMAGE TO THIS EQUIPMENT WILL NOT BE COVERED UNDER KWIK GOAL'S PRODUCT GUARANTEE. DO NOT LEAVE THIS EQUIPMENT UNATTENDED.

18. Attach center cover to crossbar at all grommet locations with cover clips.
19. Pull center cover over frame bows, starting at one base corner, attach center cover to base at all grommeted locations with base bungees. Attach center cover to frame bows on left and right sides as shown.
- Note: One person hold corner of center cover while the other attach bungees base corner and bow.**

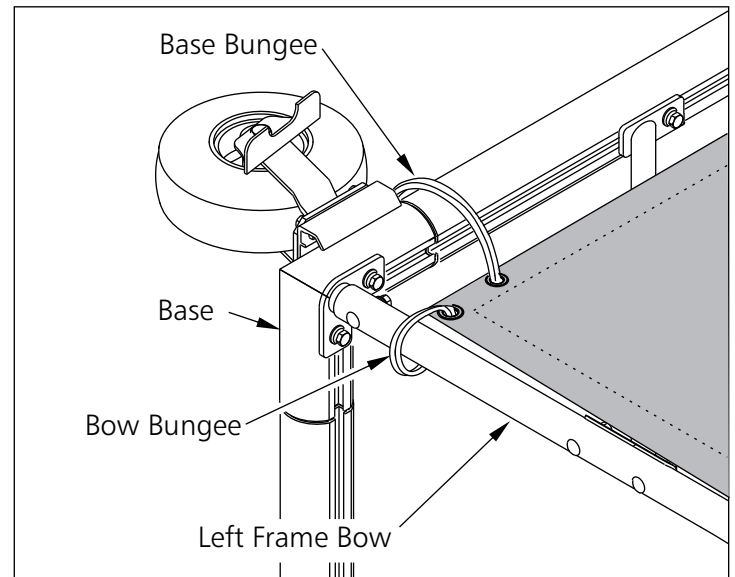
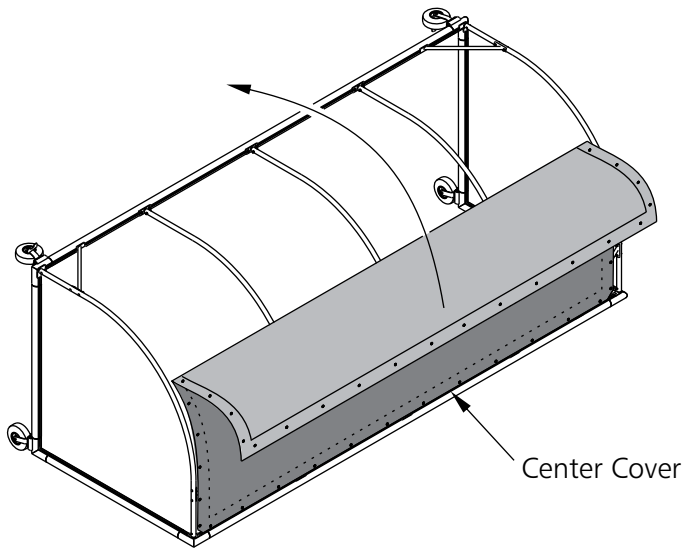

20. After center cover is completely attached, turn shelter up on wheels and engage brakes on swivel wheels w/brake.

Note: For a clean look keep bungee balls on the inside of cover

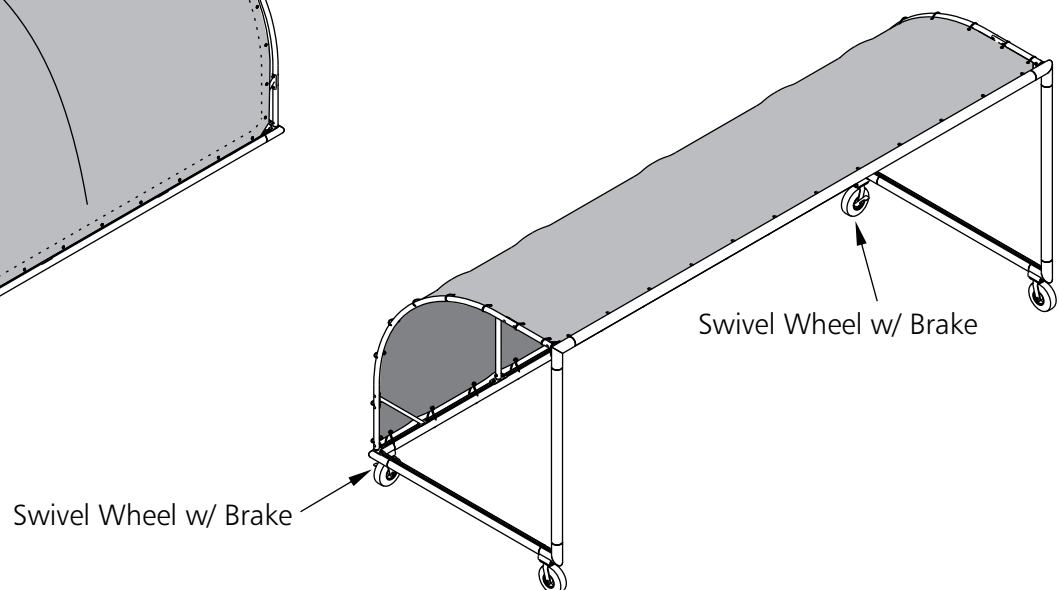
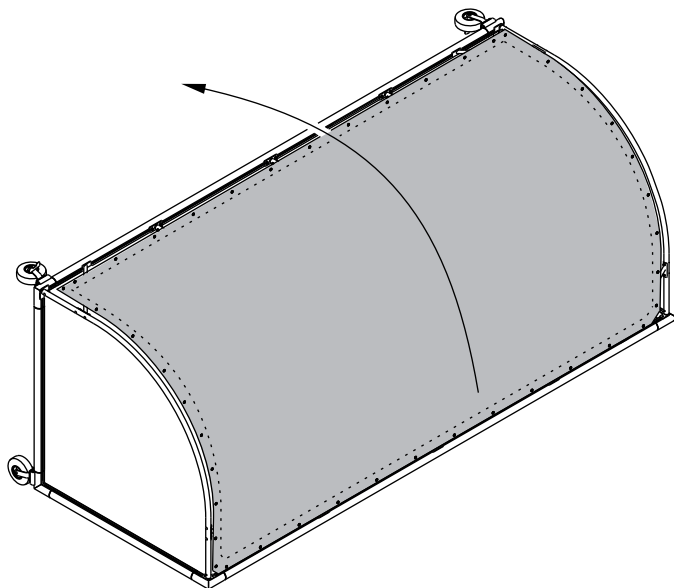

THIS UNIT MUST BE ANCHORED ACCORDING TO THESE INSTRUCTIONS AT ALL TIMES

⚠ WARNING

THIS EQUIPMENT MUST BE STORED IN A SECURED, SHELTERED AREA WHEN NOT IN USE OR IN THE THREAT OF HIGH WINDS. ANY WEATHER DAMAGE TO THIS EQUIPMENT WILL NOT BE COVERED UNDER KWIK GOAL'S PRODUCT GUARANTEE. DO NOT LEAVE THIS EQUIPMENT UNATTENDED.

21. On left side cover, find angled corner and with the hem edge inside, attach angled corner to frame bow with bow bungee. With bow bungee holding corner, attach left side cover to the left post with cover clips.

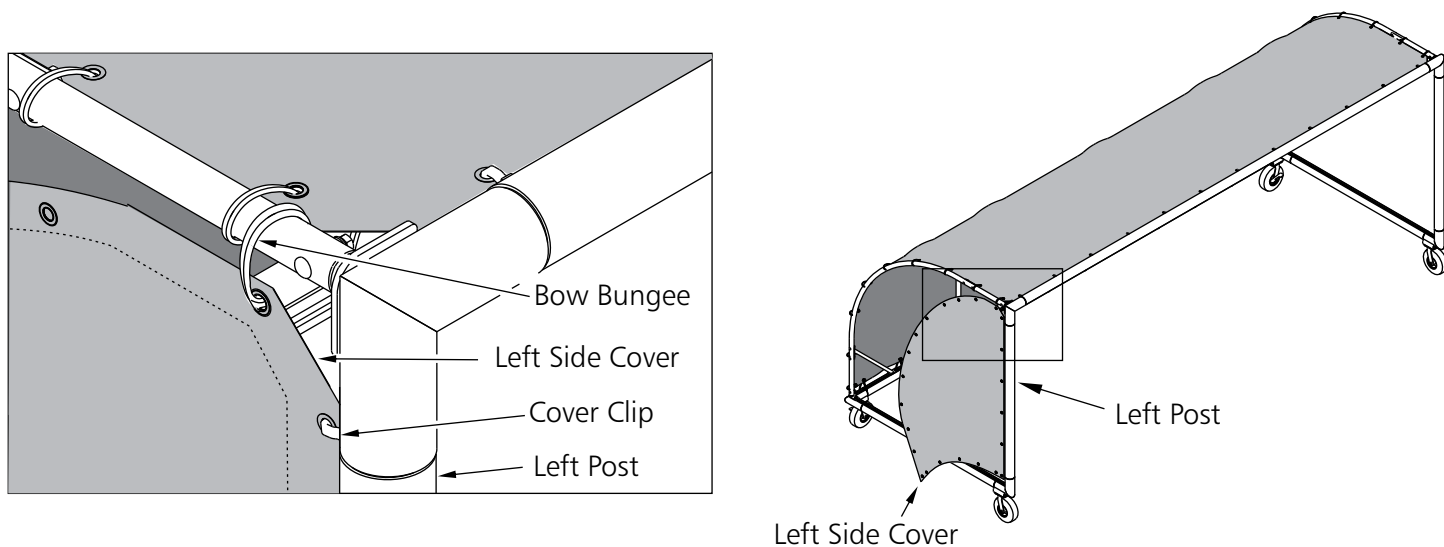

22. Attach left side cover to base and bow starting at the left base corner.
Note: Be sure to use base and bow bungees in proper locations.

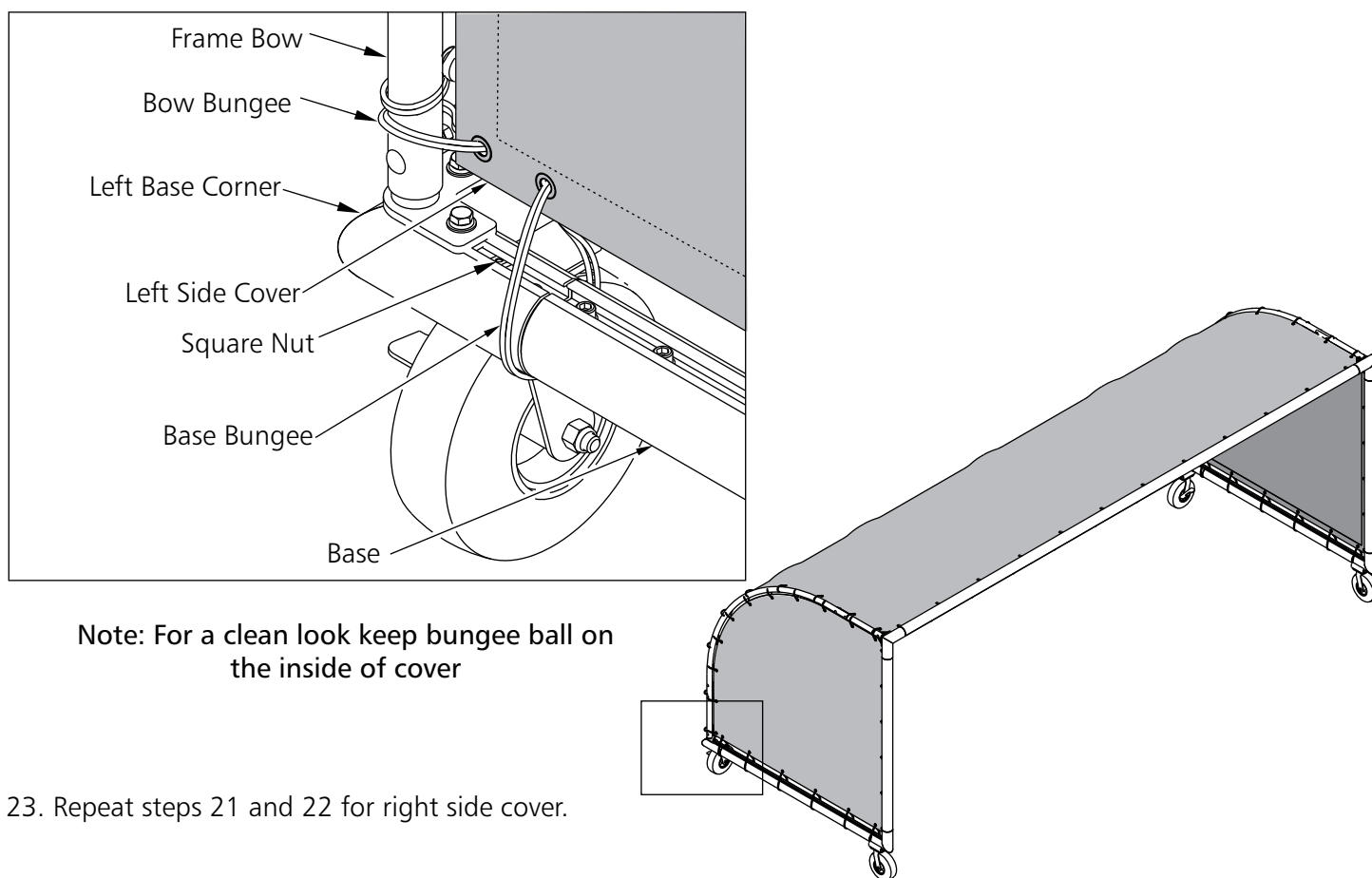

23. Repeat steps 21 and 22 for right side cover.

THIS UNIT MUST BE ANCHORED ACCORDING TO THESE INSTRUCTIONS AT ALL TIMES

⚠ WARNING

THIS EQUIPMENT MUST BE STORED IN A SECURED, SHELTERED AREA WHEN NOT IN USE OR IN THE THREAT OF HIGH WINDS. ANY WEATHER DAMAGE TO THIS EQUIPMENT WILL NOT BE COVERED UNDER KWIK GOAL'S PRODUCT GUARANTEE. DO NOT LEAVE THIS EQUIPMENT UNATTENDED.

24. Hardware for step 24 is in **Anchor Hdw** pack.
Attach anchor plates and chains to bases as shown below.

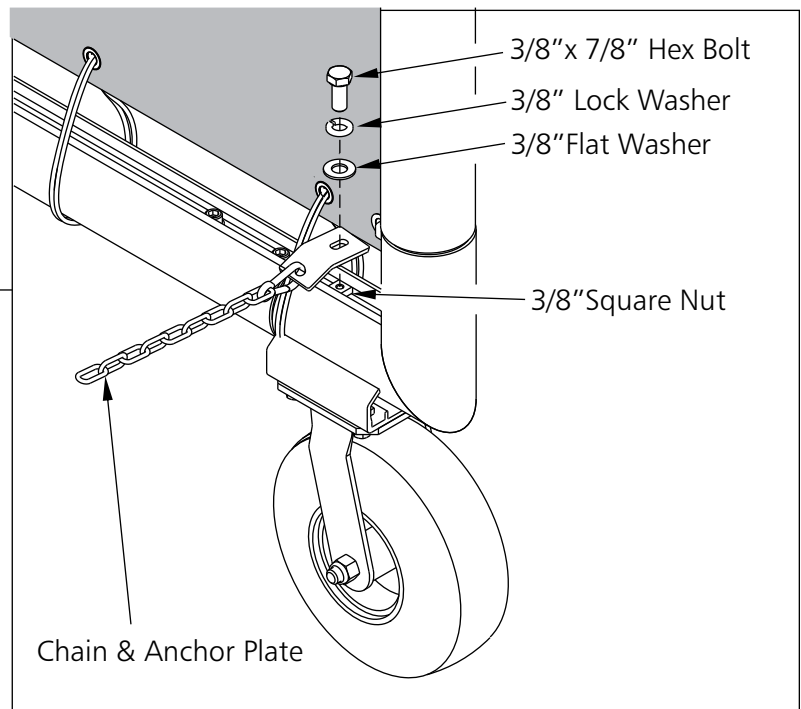
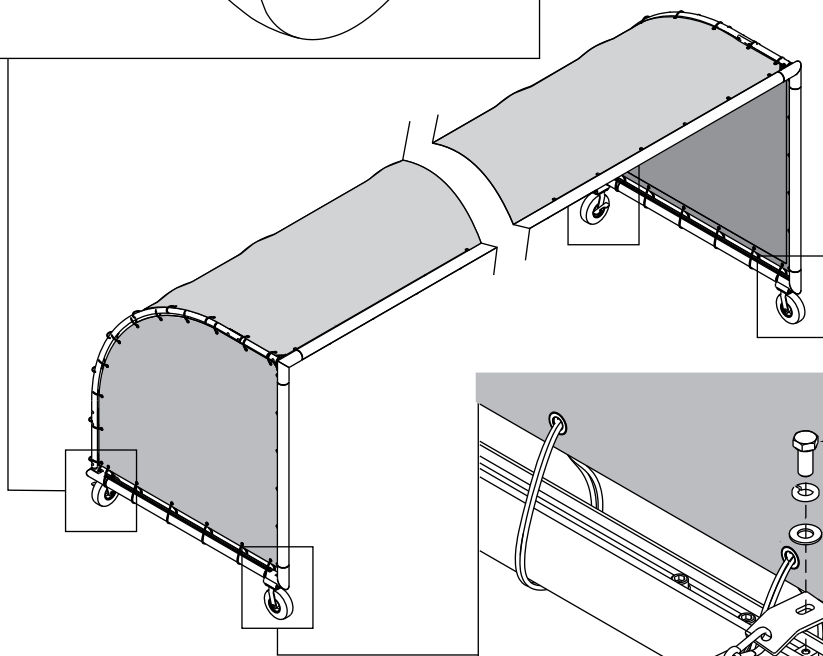
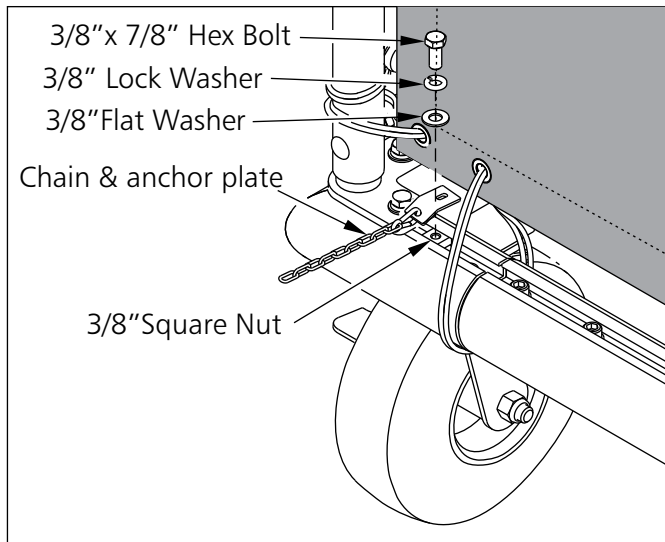

THIS UNIT MUST BE ANCHORED ACCORDING TO THESE INSTRUCTIONS AT ALL TIMES

⚠ WARNING

THIS EQUIPMENT MUST BE STORED IN A SECURED, SHELTERED AREA WHEN NOT IN USE OR IN THE THREAT OF HIGH WINDS. ANY WEATHER DAMAGE TO THIS EQUIPMENT WILL NOT BE COVERED UNDER KWIK GOAL'S PRODUCT GUARANTEE. DO NOT LEAVE THIS EQUIPMENT UNATTENDED.

25. Permanent ground anchors must be used at all times.
Dig four holes according to the layout below.
Note: Areas subject to heavy frost may require depths as deep as 36". Prepare holes and add drain stone as shown. Install anchor in each hole and fill hole with concrete. Allow concrete to cure before attaching shelter to anchors.

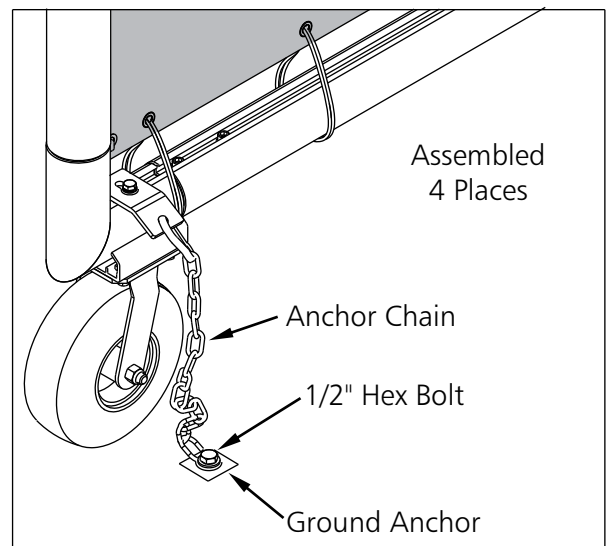
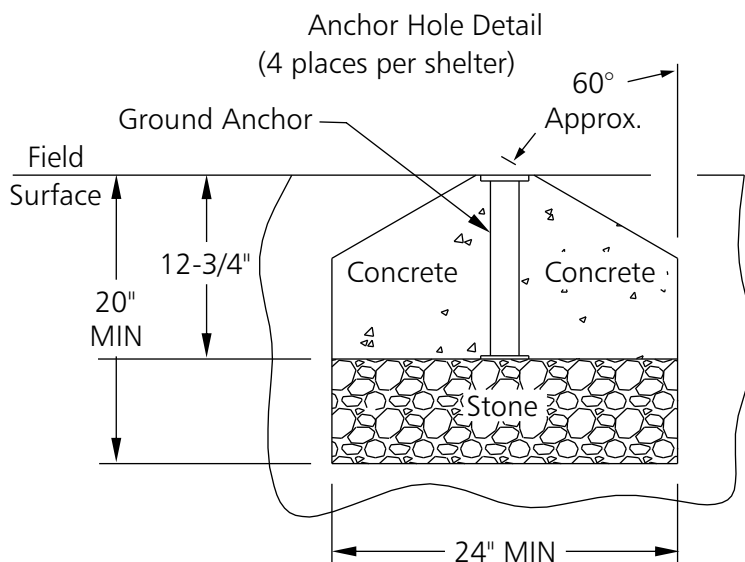
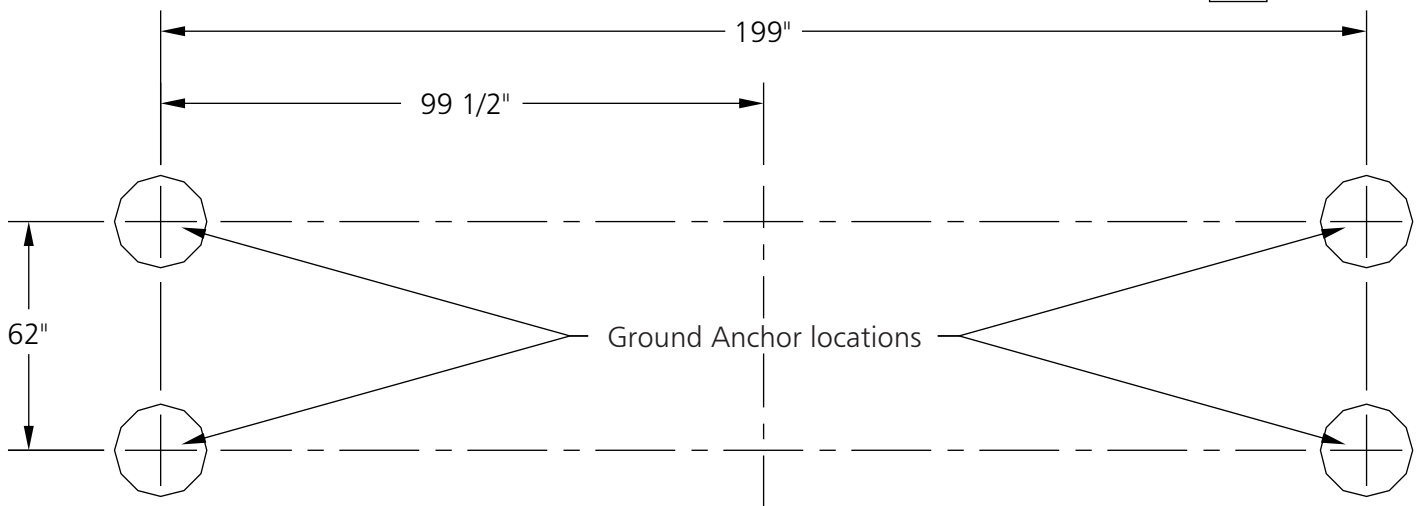
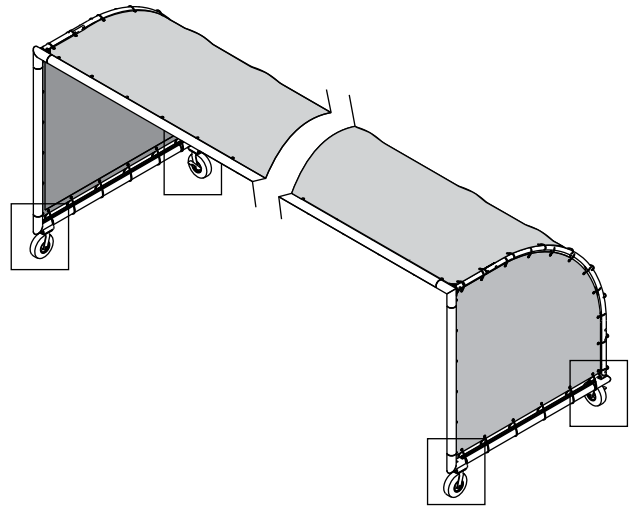

THIS UNIT MUST BE ANCHORED ACCORDING TO THESE INSTRUCTIONS AT ALL TIMES

⚠ WARNING

THIS EQUIPMENT MUST BE STORED IN A SECURED, SHELTERED AREA WHEN NOT IN USE OR IN THE THREAT OF HIGH WINDS. ANY WEATHER DAMAGE TO THIS EQUIPMENT WILL NOT BE COVERED UNDER KWIK GOAL'S PRODUCT GUARANTEE. DO NOT LEAVE THIS EQUIPMENT UNATTENDED.

26. The ground anchor and chain leash system supplied is the recommended and the safest method of anchoring your shelter. However, anchor bags may be used as a temporary anchoring system. To ensure the anchor bags remain on the base of your shelter, you must attach them as shown in figure below.

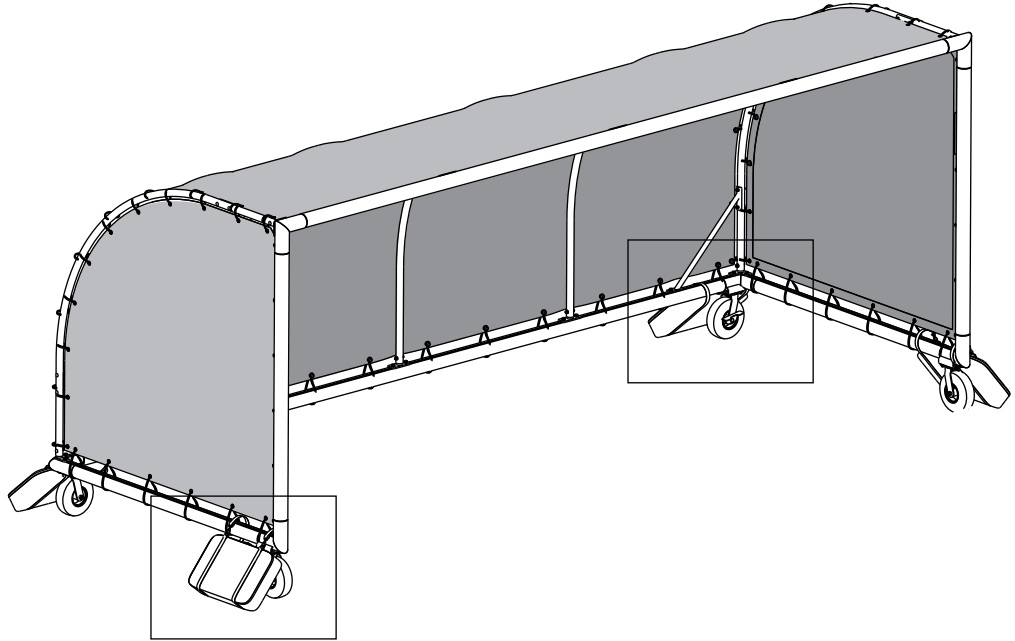

27. Disengage brakes on swivel wheels w/ brakes and move into desired location. To hold shelter in place, fill all four Kwik fill anchor bag according to instructions. Attach Kwik fill anchor bags to shelter base at locations as shown. Also engage brakes on swivel wheel w/ brake.

Front Anchor Bag Placement

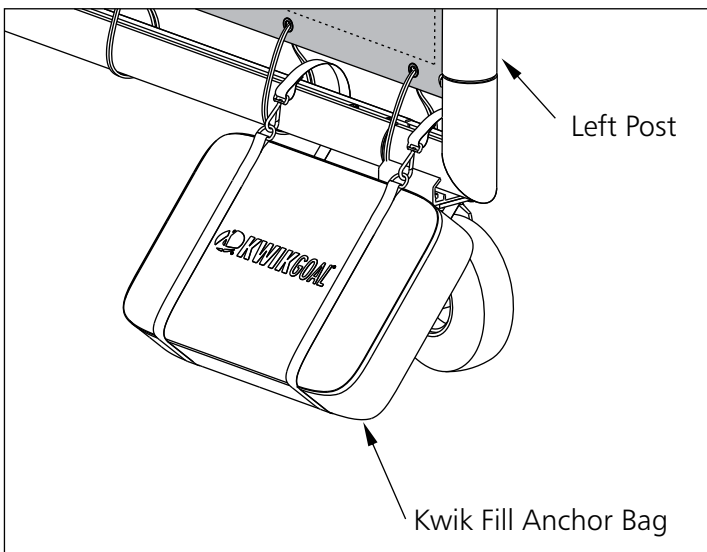

Rear Anchor Bag Placement

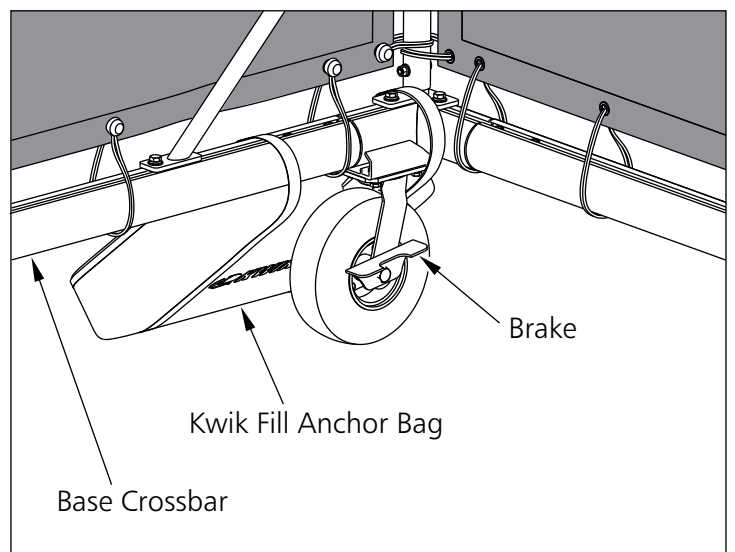

Go to kwikgoal.com for additional product information.

THIS UNIT MUST BE ANCHORED ACCORDING TO THESE INSTRUCTIONS AT ALL TIMES

⚠ WARNING

THIS EQUIPMENT MUST BE STORED IN A SECURED, SHELTERED AREA WHEN NOT IN USE OR IN THE THREAT OF HIGH WINDS. ANY WEATHER DAMAGE TO THIS EQUIPMENT WILL NOT BE COVERED UNDER KWIK GOAL'S PRODUCT GUARANTEE. DO NOT LEAVE THIS EQUIPMENT UNATTENDED.